



2025 CATALOG



NEW

AD AnyDoor
9' BUTT HINGE TEMPLATE KIT

SHARPENING



ROUTERS



**ROUTING
TABLES**



PPE



ACCESSORIES



TIME SAVING SOLUTIONS FOR THE TRADE

CONTENT

Trend prides itself on continually developing new and innovative time saving products for tradespeople.

Our New Products pages are full of exciting new lines in a range of categories including Power Tools, PPE, Abrasives & Jigs.

DOOR FITTING SOLUTIONS	4-5	DRILLING	
ROUTERS		CABINETY TOOLS	34
T1 & T8 ROUTERS	6-7	POCKET HOLE JIGS	34
ROUTER TABLES		UNIVERSAL COUNTERSINK	35
CRT & WRT ROUTER TABLES	8-9	JOINTING	
ROUTER BITS & ROUTER BIT SETS		LOOSE TENONS	35
ROUTER BITS	10-15	JOINTING BISCUITS	35
ROUTER BIT SETS	16-23	VARIJIGS AND ACCESSORIES	
DIAMOND SHARPENING SOLUTIONS		VARIJIGS	36-37
DOUBLE-SIDED SLIP STONES	24-25	BEARINGS	37
BENCH STONES	25	COLLET EXTENSIONS	37
DIAMOND FILES & TOOL BIT CLEANER	26-27	ACCESSORIES	38
DIAMOND KITS	28	MEASURING AND MARKING	
SHARPENING ACCESSORIES	29	DIGITAL LEVEL BOX	39
DOOR HANGING		MULTISCRIBE	39
ANYDOOR & ANYDOOR BUNDLES	30-31	DIGITAL DEPTH GAUGE	39
LOCK JIGS	32	PPE	
DOOR HANGING ACCESSORIES	33	AIRSHIELD PRO & AIRSHIELD PRO BUNDLES	40-41
		ABRASIVES	
		ABRASIVE PADS & PAD SAVERS	42-47

⚠️ WARNINGS

California Proposition 65

Some products sold in this catalog and on our website, may contain chemicals or materials listed on the Proposition 65 Harmful substance list. For details, please see individual product webpages for full safety sheets and certifications. If you would like to find out more information on Proposition 65 and what it means, please visit the official Prop65 information website www.p65warnings.ca.gov

Please note: The following links take you to an external website, Trend Machinery & Cuttings Tools Ltd, can not be held responsible for the content of third party websites.

⚠️ Wood Dust

WARNING: Drilling, sawing, sanding or machining wood products can expose you to wood dust, a substance known to the State of California to cause cancer. Avoid inhaling wood dust or use a dust mask or other safeguards for personal protection. For more information go to www.p65warnings.ca.gov/wood

⚠️ Diamond Sharpening, Hand Tools.

WARNING: The metal parts of this product contain Nickel compounds, a substance known to the State of California to cause cancer. None of these products are to come in contact with food and drinking water. Please wash your hands with soap and water after touching these products. For more information go to www.p65warnings.ca.gov

⚠️ Electrical Cords

WARNING: The wires of this product contain Nickel compounds, a substance known to the State of California to cause cancer. None of these products are to come in contact with food and drinking water. Please wash your hands with soap and water after touching these products. For more information go to www.p65warnings.ca.gov

⚠️ Lapping Fluid

WARNING: This Petroleum based product can expose you to chemicals including Toluene and Benzene, which are known to the State of California to cause cancer and birth defects or other reproductive harm. For more information go to www.p65warnings.ca.gov/petroleum

⚠️ Air Circulating Face Shield and Accessories

WARNING: This product can expose you to chemicals including Bisphenol A, which is known to the State of California to cause birth defects or other reproductive harm. For more information go to www.p65warnings.ca.gov

⚠️ Honing Compound

WARNING: This product can expose you to Titanium Dioxide, which is known to the State of California to cause cancer. For more information go to www.p65warnings.ca.gov

COPYRIGHT

© 2019 Trend Routing Technology Inc. All rights reserved. No part of this publication may be reproduced or transmitted without prior permission. Trend Routing Technology Inc. cannot be held liable for any material rendered unusable, or for any form of consequential loss. The descriptions specifications and other claims made with respect to the products featured in this catalog are made as of the date of printing. Trend Routing Technology Inc. retains the right to discontinue production of or make improvements or other changes to any of its products without notice. Product packaging and other product literature should be consulted for current descriptions specifications and other claims relating to Trend Routing Technology Inc. products. Improvements or other changes to products shall not obligate Trend Routing Technology Inc. to make corresponding improvements or changes to products previously manufactured or sold. All Trademarks Acknowledged.

GUARANTEE TREND LIMITED TOOLING WARRANTY

All Trend tools are engineered and manufactured to the highest standards for optimum performance and service life. Trend warrants to the original purchaser at retail that each new Trend tool shall be free from defects in material and workmanship, subject to the guidelines below. Upon verification of failure or malfunction, Trend shall, at its option, within 28 days, repair or replace the tool. Subject to the guidelines below.

Guidelines

1. In the event of failure or malfunction, return the product, properly packaged and postage prepaid, to Trend Routing Technology Inc.
2. All implied warranties for Trend's power tools (INCLUDING MERCHANTABILITY AND FITNESS FOR PARTICULAR PURPOSE) are limited to the period of one year from the purchase date. Some states do not allow limitations on how long an implied warranty lasts, so the above limitation may not apply to you.
3. A warranty claim shall be limited to repair or replacement as stated in Trend's Limited Tool Warranty and in no event shall Trend be liable for any other direct, indirect or consequential damages, costs or expenses. INCIDENTAL AND CONSEQUENTIAL DAMAGES ARE EXCLUDED UNDER ALL WARRANTIES. Some states do not allow the exclusion or limitation of incidental or consequential damages, so the above may not apply to you.
4. Trend warranties give you specific legal rights, and you may also have other rights, which vary from state to state.
5. Trend warranties shall not be deemed to have failed their essential purpose while Trend is willing to repair or replace defective products.
6. Trend assumes no liability for defects or damage caused by abuse or misuse of any product or unauthorised service of any product. The product must have been used for its recommended purpose and not modified by sharpening or other changes. Normal wear and tear are not covered under Trend warranties.
7. Any action for breach of warranty must be commenced within one year after the accrual of the cause of action.

NEW PRODUCTS

AD AnyDoor

**9' BUTT HINGE
TEMPLATE KIT**



NEW

**DOOR FITTING
SOLUTIONS**



T1
5.5A 1/4"
TRIM AND
PLUNGE
ROUTER



NEW

T8
3HP
15A 1/2"
DUAL-MODE
PLUNGE
ROUTER



**WRT -
WORKSHOP
ROUTER
TABLE**



NEW

**CRT - PORTABLE
ROUTER TABLE**



NEW

SHARPENING



NEW

ABRASIVES

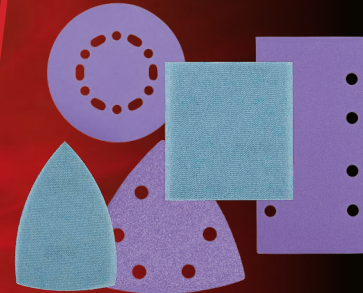

NEW

NEW



**POCKET
HOLE JIG**



**TWIN
POCKET
HOLE JIG**



**PRO
POCKET
HOLE JIG**



**3 IN 1
POCKET
HOLE JIG**



**SINGLE
POCKET
HOLE JIG**

**35mm
CONCEALED
CABINET
HINGE**



NEW

**CABINET
HARDWARE
DRILLING JIG**

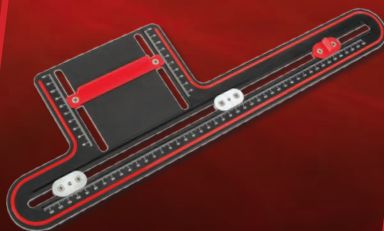

NEW

LOOSE TENONS



NEW

**WOODEN
BISCUITS**



NEW

DOOR FITTING SOLUTIONS

Hanging a door perfectly but quickly and efficiently requires the right tools for the job. Trend has the complete solution. Here is a small selection of innovative products which will help you every step of the way.

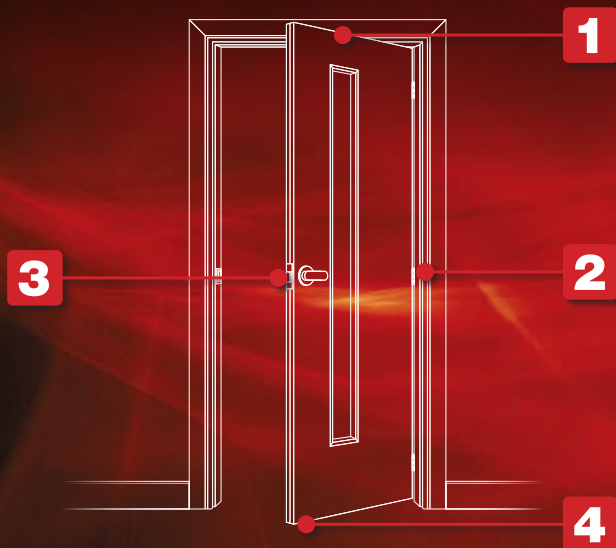

1 DOOR PREPARATION



Scribing



See pages 33 & 39



2 HINGE FITTING



Hinge Jigs and Cutters



See pages 30-31



3 LOCK FITTING



Lock Jigs and Cutters



See pages 32



4 DOOR LIFTING



Door Stand



See pages 33



Door Clamp



See pages 33



Door Lift



See pages 33

ADDITIONAL TOOLS



Routers



See pages 6-7



Corner Chisel



See pages 33

T1 5.5A 1/4" TRIM AND PLUNGE ROUTER

NEW

Flexible, light and compact router available in two configurations. Engineered to deliver reliable, fast, accurate cuts. Perfect for grooving, hinge cutting and timber profiling.

120V

5.5 A **5.5A Powerful Motor**



Extended Trim Base



2-23/64" Plunge Depth**



Precision Centring System



6 Level Variable Speed Control



Constant Speed Control



Double Locking Collet



Fine Height Adjuster



3-Position Rotating Turret



U*T1EPS

ALSO AVAILABLE AS TRIM BASE ONLY



** U*T1EPS Plunge Base only



T8

3HP 15A 1/2" DUAL-MODE PLUNGE ROUTER

NEW

ROUTERS

Engineered for both handheld and router table use.
Ideal for lock mortising, kitchen fitting, worktop
jointing and timber profiling.

120V



3-9/64" Plunge Depth



Precision Centring System



Router Table Compatible



Constant Speed Control



11-Level Variable Speed Control



Vertical Extraction Spout



Twin LED Worklights



Extra-Wide 2-61/64" Base Aperture



Trend Base Configuration



U*T8EK

*Online registration required



trend 7
tool technology

ROUTER TABLES

FLOOR STANDING

WRT - WORKSHOP ROUTER TABLE

Free-standing table designed for workshop use to deliver high quality & accurate results with larger stock

120V



U*WRT

BENCHTOP

CRT - PORTABLE ROUTER TABLE

Portable benchtop router table for joinery, furniture, shaping & moulding applications

120V



U*CRT/MK3

JOIN THE ROUTER TABLE
REVOLUTION



www.trend-usa.com/crt-wrt-router-tables

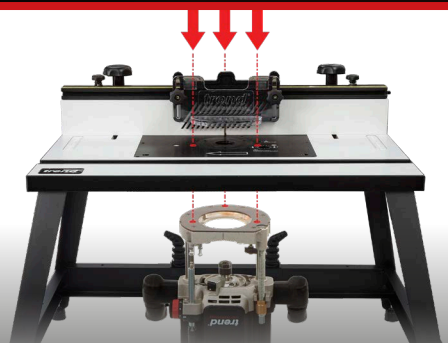

Trend Base Configuration

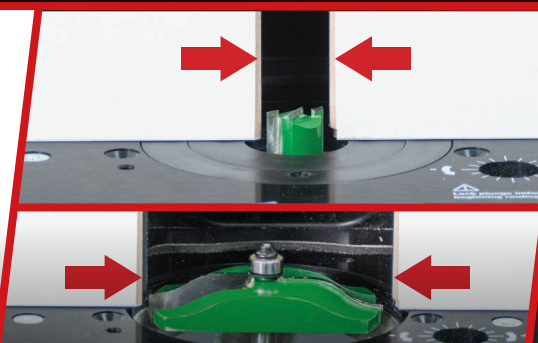

Adjustable facings for narrow and wide cutters



Mitre fence for jointing and moulding on end grain or angled work

WHY DO YOU NEED A ROUTER TABLE?

Whether working on-site or in a workshop, a router table will not only save time and money on materials, but will also greatly broaden the scope of a compatible router. The router table is a must-have for all trade and home router users.



Steel Frame Construction



Large (CRT/MK3) and Extra Large (WRT) Phenolic Tables



2-43/64" Extra-Deep Adjustable Fence



Precision Aluminium Fence Extrusion



Adjustable Melamine Fence Facings



2-1/4" Dust Extraction Port



1/4" Anodised Aluminum Router Plate



Trend Base Configuration

ACCESSORIES:

FEATHER BOARDS



LEAD-ON STARTER PIN



TRANSPARENT CUTTER GUARD



MITRE FENCE



PUSH STICK



INSERT RINGS



Combo Ring



Planing and Jointing



Tongue and Groove



Shaping



Templating Curved pieces



Batch Cutting



Panel Raising



Working with Thinner Material



User-friendly, oversized locking knobs sit above the fence for easy operation



Lead On-Starters Pin for use when templating with bearing guided cutters



Transparent Cutter Guard allows users to see the stock progression while keeping fingers away from the cutter

ROUTER BITS

STRAIGHT FLUTED TWO FLUTE

TCT
TUNGSTEN
CARBIDE
TIPPED

Suitable for a wide range of applications such as engraving, grooving, rebating and shallow mortising.

- Use on softwoods, hardwoods, MDF, plywood and chipboard.
- All bits have a bottom cut feature.
- Metric diameters from 2mm to 50mm.



KEY TO PRODUCT REFERENCES

★ Solid Carbide insert. Handle small diameter cutters with care, take shallow passes.

✧ Centre tip for plunge cutting in abrasive materials

● No centre TC tip, so not suitable for plunging abrasive materials.

W For use with Trend Worktop Jigs.

H For use with Trend Hinge Jigs.

Micrograin Carbide Tipped router bits for use on hardwood, softwood, fiberboard, plywood and particle board.

- Micrograin Carbide Tips to ensure a perfect sharpness for extra life.
- Bits made to European Safety Standard EN847-1/2 which ensures quality materials are used. The tools are balanced and with round form to reduce user injury.
- Two fluted unless specified otherwise.

D Inch	D mm	C Inch	C mm	Approx. O/L Inch	Approx. O/L mm	Shank Dia.	Other Info	Product Code
1/2	12.7	3/4	19.1	2 3/4	70.0	1/4		U*3/80LX1/4TC
1/2	12.7	2	50.8	3 35/64	90.0	1/2		U*BR01/3
1/2	12.7	2	50.8	3 35/64	90.0	1/2		U*BR01/5
1/4	6.3	3/4	19.1	2 29/64	62.5	1/4		U*C007X1/4TC
1/4	6.3	1	25.4	2 45/64	68.7	1/4		U*C008X1/4TC
5/16	7.9	3/4	19.1	2 1/3	68.5	1/4		U*C011X1/4TC
3/8	9.5	1	25.4	2 19/32	66.0	1/4		U*C014X1/4TC
3/8	9.5	1 1/4	31.8	2 55/64	72.5	1/4		U*C015X1/4TC
15/32	12	3/4	19.1	2 3/4	70.0	1/4	✧ H	U*C019AX1/4TC
1/2	12.7	1	25.4	2 19/32	66.0	1/4		U*C021X1/4TC
1/2	12.7	1 1/4	31.8	2 55/64	72.5	1/4		U*C022X1/4TC
5/8	15.9	3/4	19.1	2 11/32	59.5	1/4		U*C025X1/4TC
3/4	19.1	3/4	19.1	2 11/32	59.5	1/4		U*C029X1/4TC
25/32	20	1 1/2	37	3 5/64	78.0	1/2		U*C030DX1/2TC
3/4	19.1	1	25.4	2 33/64	64.0	1/2		U*C030X1/2TC
3/4	19.1	1	25.4	2 19/32	66.0	1/4		U*C030X1/4TC
1	25.4	3/4	19.1	2 9/32	58.0	1/2		U*C033X1/2TC
1	25.4	3/4	19.1	2 33/64	60.0	1/4		U*C033X1/4TC
1/2	12.7	2	50	3 11/16	93.5	1/2		U*C153/3
1/2	12.7	2	50	3 5/8	93.0	1/2	✧ W	U*C153DX1/2TC
1/2	12.7	2	50	3 11/16	93.5	1/2	W	U*C153X1/2TC
1/2	12.7	2 1/2	63	4 9/64	105.0	1/2	W	U*C164X1/2TC
15/32	12	2 1/2	63	4 3/8	111.0	1/2		U*C172X1/2TC



TRIMMING

Used for trimming plastic or plywood overlays.

- Also for copy profiling with a template.

TCT
TUNGSTEN
CARBIDE
TIPPED

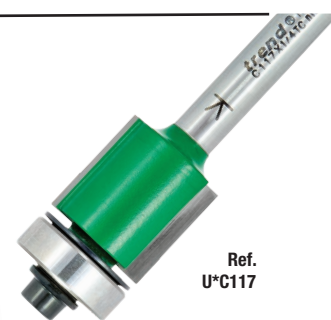
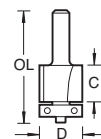

Ref.
U*C117

D Inch	D mm	C Inch	C mm	B Inch	B mm	A	Approx. O/L Inch	Approx. O/L mm	Shank Dia.	Other Info	Product Code
3/8	9.5	1	25.4	3/8	9.5	90	3	75.0	1/4		U*C115AX1/4TC
3/8	9.5	1/2	12.7	3/8	9.5	90	3	75.0	1/4		U*C115X1/4TC
1/2	12.7	5/8	16	1/2	12.7	90	2 43/64	68.0	1/4		U*C116AX1/4TC
1/2	12.7	1	25.4	1/2	12.7	90	3 1/8	79.5	1/2		U*C116X1/2TC
1/2	12.7	1	25.4	1/2	12.7	90	3	77.0	1/4		U*C116X1/4TC
1/4	6.35	1/2	12.7	1/4	6.35	90	2 13/32	61.1	1/4		U*C167X1/4TC
1/4	6.35	1	25.4	1/4	6.35	90	2 7/8	73.0	1/4		U*C168X1/4TC
1/2	12.7	2	50	1/2	12.7	90	4 1/8	104.5	1/2		U*C195X1/2TC
1/2	12.7	1 1/2	38	1/2	12.7	90	3 5/8	92.0	1/2		U*C196X1/2TC
3/4	19.1	1 31/32	50	3/4	19	90	4 3/16	106.5	1/2		U*C199X1/2TC

BISCUIT JOINTER SET

TCT
TUNGSTEN
CARBIDE
TIPPED

This two wing self-guiding Micrograin Carbide Tipped slotting bit is ideal for biscuit jointing.

- The set is supplied with three ball bearing guides to suit the three sizes of biscuits available.
- A slightly longer cut than the length of the biscuit is required for ease of alignment during assembly.



Ref.
U*C152

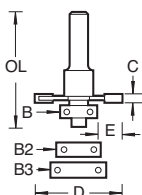
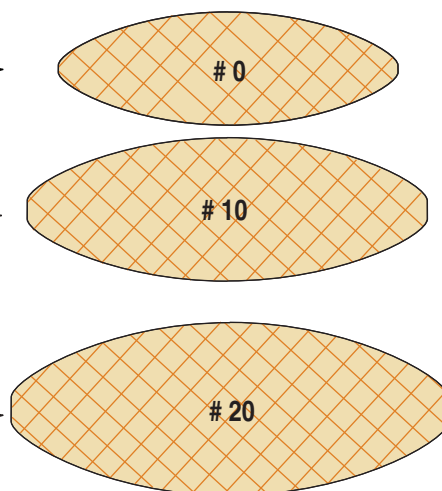
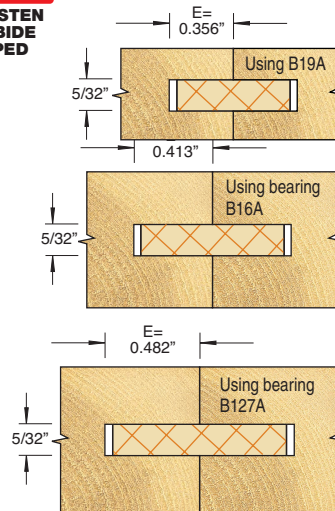

D Inch	D mm	C Inch	C mm	B Inch	B mm	B2 Inch	B2 mm	B3 Inch	B3 mm	Approx. O/L Inch	Approx. O/L mm	Shank Dia.	Other Info	Product Code
1 1/2	37.2	5/32	4	1/2	12.7	5/8	16	3/4	19	2 33/64	64.0	1/2		U*C152X1/2TC
1 1/2	37.2	5/32	4	1/2	12.7	5/8	16	3/4	19	2 1/2	63.5	1/4		U*C152X1/4TC

SLOTTING

TCT
TUNGSTEN
CARBIDE
TIPPED

Two wing Micrograin Carbide Tipped slotting bits.

- A 1/2-inch diameter bearing is supplied with every bit giving a 3/8-inch groove depth.
- Depth of cut can be changed by purchasing alternative bearing sizes.
- Easy to set-up and use, hex key is supplied.

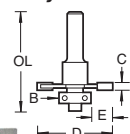

N.B. The grooving section cannot be detached from the shank.

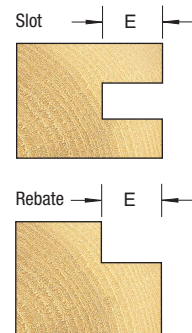
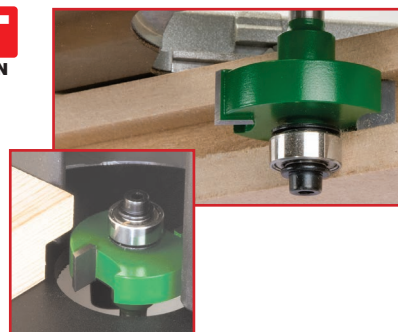

Ref.
U*C145

D Inch	D mm	C Inch	C mm	B Inch	B mm	E Inch	E mm	Approx. O/L Inch	Approx. O/L mm	Shank Dia.	Other Info	Product Code
1 1/4	31.8	1/4	6.3	1/2	12.7	3/8	9.5	2 9/16	65.0	1/4		U*C145X1/4TC
1 1/4	31.8	3/8	9.5	1/2	12.7	3/8	9.5	2 43/64	68.0	1/4		U*C147X1/4TC

GUIDED ROUND OVER

For producing beads and rounding over edge moulds.

- The set is supplied with two ball bearing guides.
- Use the larger bearing for a round over.

TCT
TUNGSTEN
CARBIDE
TIPPED

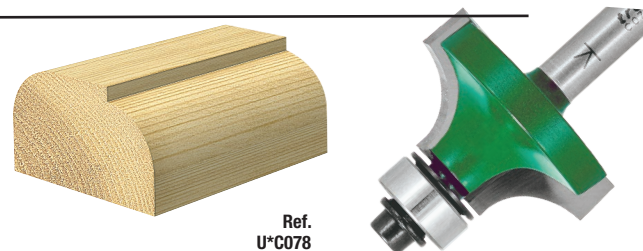
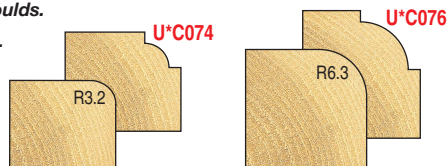

Ref.
U*C078

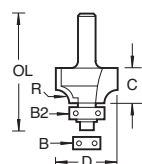

with alternative bearing

D Inch	D mm	C Inch	C mm	B Inch	B mm	B2 Inch	B2 mm	R Inch	R mm	Approx. O/L Inch	Approx. O/L mm	Shank Dia.	Other Info	Product Code
3/4	19	3/8	9.5	3/8	9.5	1/2	12.7	1/8		2 13/32	61.0	1/4		U*C074X1/4TC
7/8	22	1/2	12.7	3/8	9.5	1/2	12.7	3/16	4.8	2 35/64	64.5	1/4		U*C075X1/4TC
1	25.4	1/2	12.7	3/8	9.5	1/2	12.7	1/4	6.3	2 33/64	64.0	1/4		U*C076X1/4TC
1 1/8	28.5	1/2	12.7	3/8	9.5	1/2	12.7	5/16	7.9	2 33/64	64.0	1/4		U*C077X1/4TC
1 1/4	31.7	5/8	15.9	3/8	9.5	1/2	12.7	3/8	9.5	2 5/8	67.5	1/4		U*C078X1/4TC
1 1/2	38	3/4	19.1	3/8	9.5	1/2	12.7	1/2	12.7	2 45/64	68.5	1/2		U*C079X1/2TC
1 1/2	38	3/4	19.1	3/8	9.5	1/2	12.7	1/2	12.7	2 25/35	70.5	1/4		U*C079X1/4TC
1 3/4	44.5	7/8	22	3/8	9.5	1/2	12.7	5/8	16	2 53/64	72.0	1/2		U*C198X1/2TC

BEARING GUIDED REBATE SETS

TCT
TUNGSTEN
CARBIDE
TIPPED

Ref.
U*C040

These bits are self-guiding and can be used to produce rebates, lap joints, tongues and rebated corners.

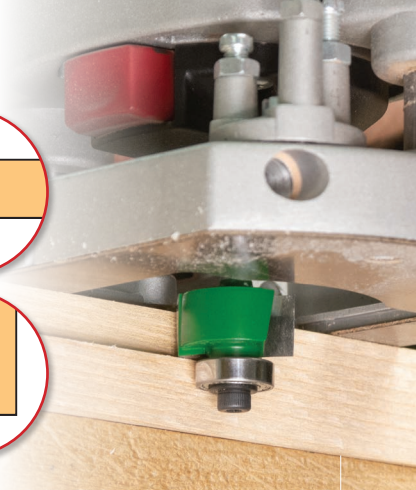
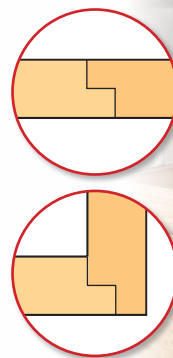
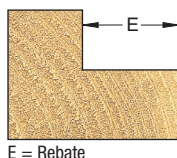
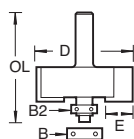

D Inch	D mm	C Inch	C mm	B Inch	B mm	B Inch	B2 mm	E Inch	E mm	Approx. O/L Inch	Approx.. O/L mm	Shank Dia.	Other Info	Product Code
1 3/8	35	1/2	12.7	3/8, 1/2	9.5, 12.7	3/8	9.5	1/2, 7/16	12.7, 11.1	2.5625	65.0	1/4		U*C040X1/4TC

GUIDED TEMPLATE PROFILER

TCT
TUNGSTEN
CARBIDE
TIPPED

Ref.
U*C121

Shank mounted bearing profilers are ideal for template guidance.

- Use for rebating and trimming edges only.

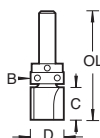

▲ Extra care must be taken to avoid cutter breakage. A max. 3mm overlap should be left before copy profiling.



Stage 1
Trimming to
a template
straight or
shaped.

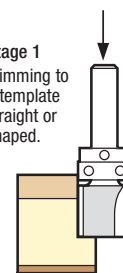

Stage 2
Trimming to
make a smooth
accurate pass.

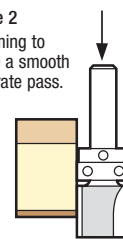

D Inch	D mm	C Inch	C mm	B Inch	B mm	A	Approx. O/L Inch	Approx. O/L mm	Shank Dia.	Other Info	Product Code
1/2	12.7	3/8	9.5	1/2	12.7	90	2 1/8	55.5	1/4		U*C121BX1/4TC
1/2	12.7	1/2	12.7	1/2	12.7	90	2 1/4	57.0	1/4		U*C121FX1/4TC
1/2	12.7	1	25.4	1/2	12.7	90	2 3/4	71.0	1/4		U*C121X1/4TC
3/4	19.1	3/4	19.1	3/4	19.1	90	2 1/2	63.5	1/2		U*C165X1/2TC
3/4	19.1	1 31/32	50	3/4	19.1	90	3 3/4	94.5	1/2		U*C166X1/2TC

CHAMFER 'V' GROOVE

TCT
TUNGSTEN
CARBIDE
TIPPED

For veining, panelling, 'V' grooving, bevelling and chamfering.

- 'V' groove tools can be used for engraving and sign writing.
- Can also be used to hide glue lines.

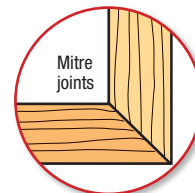
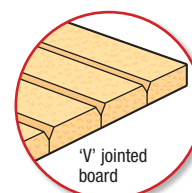

Ref.
U*C043

Ref.
U*C044

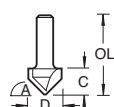

D Inch	D mm	C Inch	C mm	A	Approx. O/L Inch	Approx. O/L mm	Shank Dia.	Other Info	Product Code
1/2	12.7	7/16	11	60	2 3/32	53.0	1/4		U*C043X1/4TC
1/2	12.7	1/2	13	45	2 3/32	53.0	1/4		U*C044X1/4TC

HAVE YOU SEEN OUR RANGE OF ROUTER TABLES?
www.trend-usa.com/crt-wrt-router-tables



45° GUIDED CHAMFER

Self-guided chamfer bits for straight and shaped material.

TCT
TUNGSTEN
CARBIDE
TIPPED



Ref.
U*C049

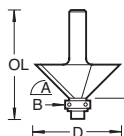
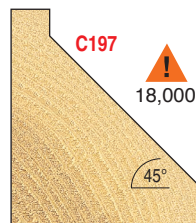
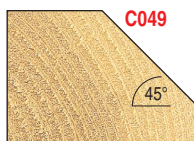

D Inch	D mm	C Inch	C mm	B Inch	B mm	A	Approx. O/L Inch	Approx. O/L mm	Shank Dia.	Other Info	Product Code
1 1/4	32	1/2	12.7	3/8	9.5	45	2 1/2	62.0	1/4		U*C049X1/4TC
2	51	3/4	19	1/2	12.7	45	2 55/64	72.5	1/2		U*C197X1/2TC

DOVETAIL

These dovetail bits produce a tight reliable joint for drawers, boxes etc.

- Refs. C041A can be used with Trend CDJ300, CDJ600 & DJ300 Dovetail Jigs.
- To suit user preference, the table shows angles from the horizontal and the profiles show angles from the vertical.
- ★ These bits have Solid Carbide inserts.

TCT
TUNGSTEN
CARBIDE
TIPPED



Ref.
U*C041

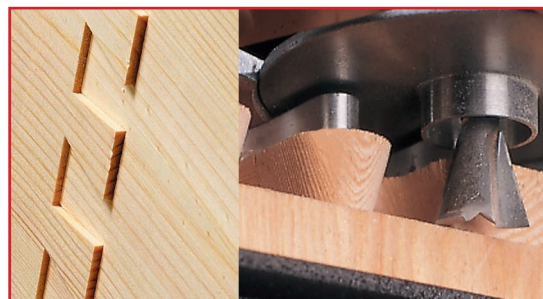
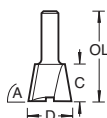
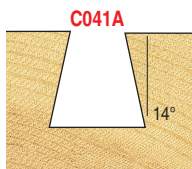

D Inch	D mm	C Inch	C mm	A	Approx. O/L Inch	Approx. O/L mm	Shank Dia.	Other Info	Product Code
1/2	12.7	1/2	12.7	104	2 3/8	61.0	1/4	★	U*C041AX1/4TC

SHANK MOUNTED BEARING GUIDED HOUSING

- Creates grooves and trenches in boards.
- Bearing follows template.
- For rebating and housings.

TCT
TUNGSTEN
CARBIDE
TIPPED



Ref.
U*C226

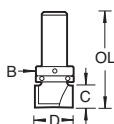

D Inch	D mm	C Inch	C mm	B Inch	B mm	Approx. O/L Inch	Approx. O/L mm	Shank Dia.	Other Info	Product Code
3/4	19.1	7/16	11.1	3/4	19.1	2 21/64	89.0	1/4		U*C226X1/4TC

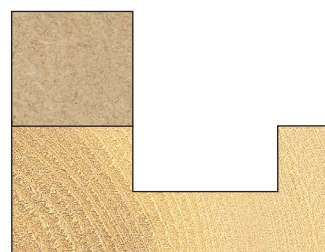
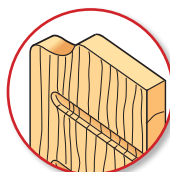

RADIUS

Two flute cove style bit gives radiused grooves for decorative panel finishes and board edges.

- For deep channels, take a series of passes.
- ★ This bit has Solid Carbide inserts rather than brazed tips.

TCT
TUNGSTEN
CARBIDE
TIPPED



Ref.
U*C054

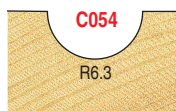
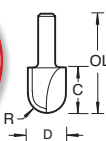
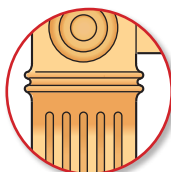

D Inch	D mm	C Inch	C mm	R Inch	R mm	Approx. O/L Inch	Approx. O/L mm	Shank Dia.	Other Info	Product Code
1/2	12.7	5/16	7.9	1/4	6.3	1 29/32	48.5	1/4		U*C054X1/4TC

BEARING GUIDED ROUND OVER & OVOLO

TCT
TUNGSTEN
CARBIDE
TIPPED

Self-guiding bit for rounding over edges do not require a side-fence.

- Supplied with two bearings.
- Use the larger bearing for a round over. If the bit is lowered, a top quirk can be produced.
- Bullnose mouldings can also be produced by taking a second pass from the opposite side of the workpiece.

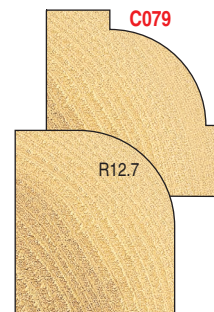
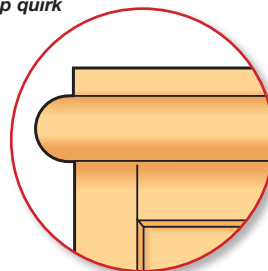

D Inch	D mm	C Inch	C mm	B Inch	B mm	B2 Inch	B2 mm	R Inch	R mm	Approx. O/L Inch	Approx. O/L mm	Shank Dia.	Other Info	Product Code
2	51	1	25.4	3/8	9.5	1/2	12.7	3/4	19.1	2 21/64	75.0	1/2		U*C079AX1/2TC

BEARING GUIDED CORNER BEAD

TCT
TUNGSTEN
CARBIDE
TIPPED

Attractive edge moulds.

- A full corner bead can be produced by making a second pass at 90°.

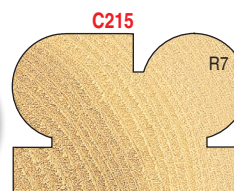
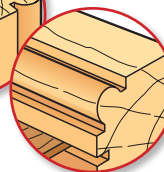
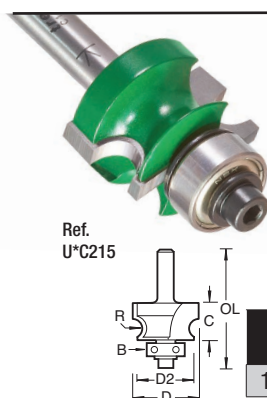

D Inch	D mm	D2 Inch	D2 mm	C Inch	B Inch	B mm	R Inch	R mm	Approx. O/L Inch	Approx. O/L mm	Shank Dia.	Other Info	Product Code
1 1/4	31.9	1 1/8	28.6	57/64	5/8	16	9/32	7	2 55/64	22.5	1/4		U*C215X1/4TC

STAIR HOUSING DOVETAIL

TCT
TUNGSTEN
CARBIDE
TIPPED

Purpose made for stair housing jigs.

- Ensures tight fit of tread in string on face edge.
- Refs. U*32/11 and U*32/13 are available in left hand (LH) and right hand (RH) rotation. RH cutters are also used with Trend Stair Jigs.

Please state LH or RH when ordering.

Trend Stair Jig Ref. STAIR/A
Recommended bits for
tread thickness:
22mm (7/8") Ref. U*32/10X1/2TC
25.4mm (1") Ref. U*32/11X1/2TC
28.5mm (1-1/8") Ref. U*32/12X1/2TC
32mm (1-1/4") Ref. U*32/13X1/2TC

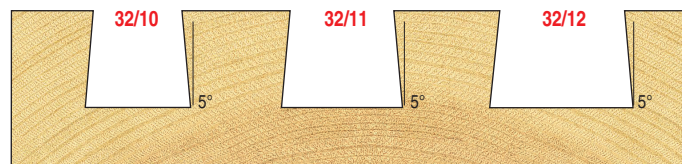
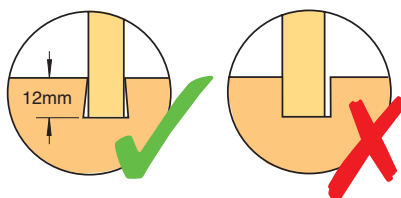
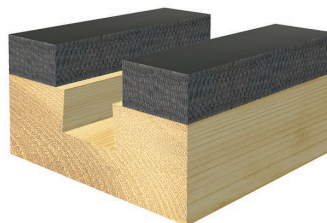
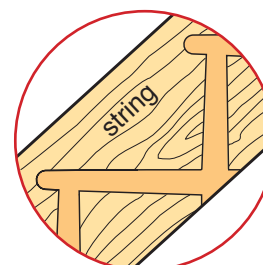

D Inch	D mm	C Inch	C mm	A	Approx. O/L Inch	Approx. O/L mm	Shank Dia.	Other Info	Product Code
35/64	14	25/32	20	95	2 9/16	65.0	1/2		U*32/10X1/2TC
5/8	15.9	1 1/32		95	2 9/16	65.0	1/2		U*32/11X1/2TC
3/4	19.1	1	25.4	95	2 9/16	65.0	1/2		U*32/12X1/2TC
55/64		1 1/32		95	2 9/16	65.0	1/2		U*32/13X1/2TC

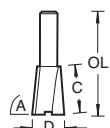

Ref.
U*T420

35mm MACHINE BITS FOR HINGE SINKING

TCT
TUNGSTEN
CARBIDE
TIPPED

- These machine bits are typically used by kitchen furniture manufacturers for recessing circular hinges.
- Group T420 TCT
This economy range is supplied without scribers and are used for recessing holes in melamine covered chipboard.

- ▲ Use sizes above 25.0mm at recommended speed range 1,000 - 3,000 RPM maximum to avoid burning.
- ▲ Use with pillar drills only.

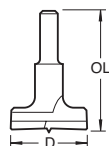

Ref: T420 Group TCT
Use economy range for melamine covered chipboard.

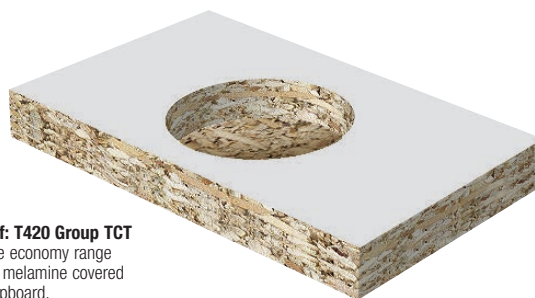

D Inch	D mm	Approx. O/L Inch	Approx. O/L mm	Shank Dia.	Other Info	Product Code
1 3/8	35	2 1/4	57.0	8mm		U*T420/35X8MMTC

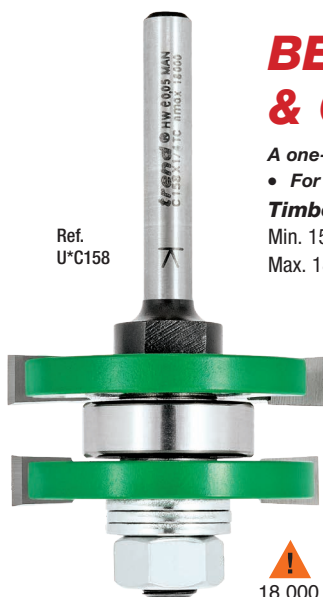
Ref.
U*C158

BEARING GUIDED TONGUE & GROOVER SET

TCT
TUNGSTEN
CARBIDE
TIPPED

A one-piece set. Parts are inter-changed on the arbor to alter the set-up.

- For use in a router table only.

Timber thickness

Min. 15.0mm

Max. 18.0mm

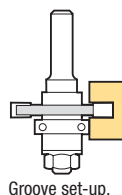
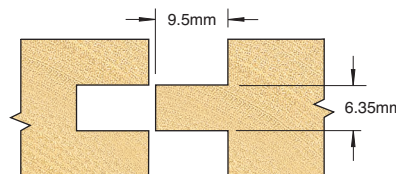
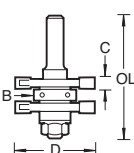

D Inch	D mm	C Inch	C mm	B Inch	B mm	Approx. O/L Inch	Approx. O/L mm	Shank Dia.	Other Info	Product Code
1 39/64	41	1/4	6.35	55/64	22	2 61/64	75.0	1/2		U*C158X1/2TC

5 PIECE MT/JIG BIT SET

A set of five long reach straight bits with diameters of 1/4 inch to 5/8 inch suitable for use with the Mortise and Tenon Jig.

TCT
TUNGSTEN
CARBIDE
TIPPED

1/2" Pack consists of:

C008X1/2TC
C012X1/2TC
C015X1/2TC
C022X1/2TC
C026X1/2TC

1/4" Pack consists of:

C008X1/4TC
C012X1/4TC
C015X1/4TC
C022X1/4TC
C026X1/4TC

Shank Dia.	Product Code
1/2	U*SET/MT1X1/2TC
1/4	U*SET/MT1X1/4TC

HAVE YOU SEEN OUR RANGE OF SHARPENING PRODUCTS?
www.trend-usa.com/applications/sharpening-with-diamond-stones



1/4" & 1/2" SHANK 6 PIECE SET

For decorative woodworking such as grooving, profiling & moulding.

- Includes 3 self-guided bits for straight and shaped work.
- For softwoods, hardwoods, MDF and plywood.

U*SET/SS11X1/4TC U*SET/SS11X1/2TC

TWO FLUTE

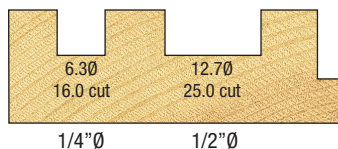

1/4" Ø

1/2" Ø

GUIDED OGEE

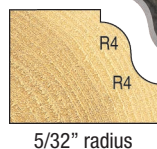

5/32" radius

GUIDED ROUND OVER



1/4" radius

3/8" radius

'V' GROOVE

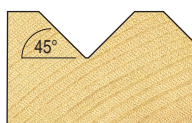

1/2" Ø

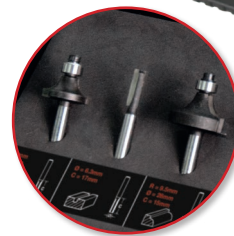

1/4" SHANK 12 PIECE SET

TCT
TUNGSTEN
CARBIDE
TIPPED

Contains a range of the most widely used bits for decorative woodworking.

- For softwood, hardwood, chipboard, plywood and MDF.
- Includes seven self-guided bits for decorating edge moulding of straight and curved components.

U*SET/SS8X1/4TC

TWO FLUTE



1/4" Ø

1/2" Ø

GUIDED REBATER

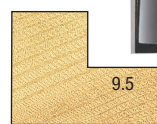

3/8" rebate

GUIDED TRIMMER

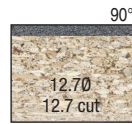

1/2" Ø

'V' GROOVE



1/2" Ø

GUIDED CHAMFER

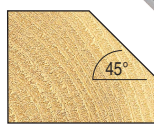

1/2" Ø

GUIDED OGEE

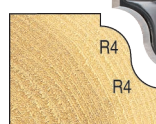

5/32" radius

GUIDED COVE



1/4" radius

CORE BOX



1/4" radius

GUIDED ROUND OVER



1/4" radius

3/8" radius

DOVETAIL

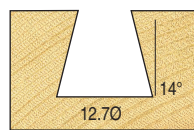

1/2" Ø



1/2" SHANK 15 PIECE SET

A fifteen piece set containing a selection of popular bits.

- For softwood, hardwood, chipboard, plywood and MDF.
- Includes eight self-guided bit for straight and shaped work.

U*SET/SS9X1/2TC



Grooving with a two flute.



Ogee cutter fitted in a router.



Rounding over a mould.



ROUTER BIT SETS

SINGLE FLUTE

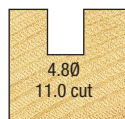

3/16" Ø



TWO FLUTE

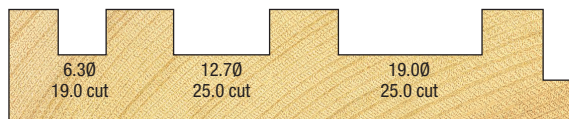

1/4" Ø

1/2" Ø

3/4" Ø

TCT
TUNGSTEN
CARBIDE
TIPPED



GUIDED TRIMMER

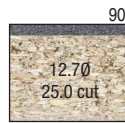

1/2" Ø



GUIDED REBATER



7/16" rebate



DOVETAIL

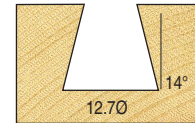

1/2" Ø

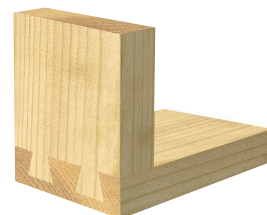

GUIDED ROUND OVER



3/8" radius



1/2" radius



CORE BOX

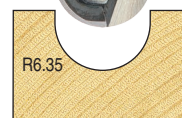

1/4" radius

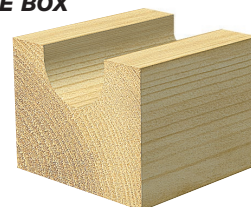

GUIDED CHAMFER

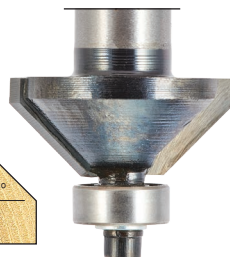
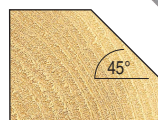

GUIDED COVE



1/4" radius



1/2" radius

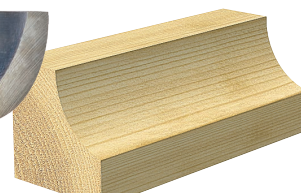

GUIDED OGE

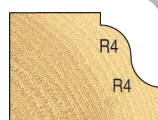

5/32" radius



'V' GROOVE

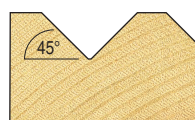

1/2" Ø



1/4" SHANK 24 PIECE SET

Contains a range of widely used bits for decorative woodworking.

- For softwood, hardwood, chipboard, plywood and MDF.
- Excellent value for money.
- Includes eleven self-guided bits for straight and shaped work.

U*SET/SS24X1/4TC

TCT
TUNGSTEN
CARBIDE
TIPPED



TWO FLUTE

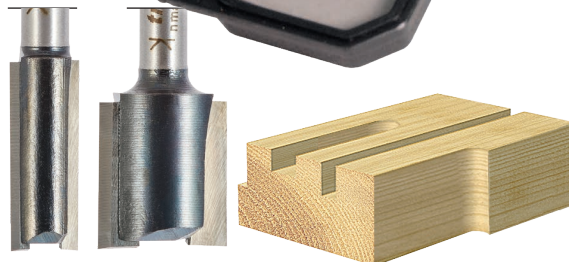
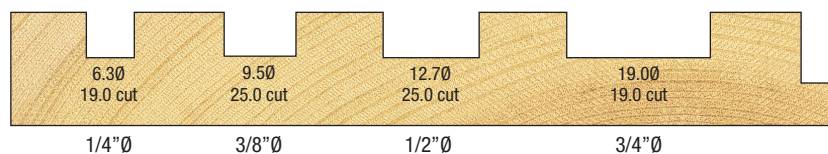

GUIDED ROUND OVER

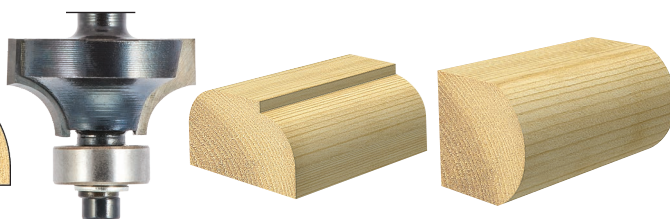
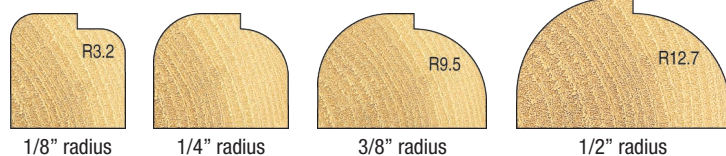

GUIDED CHAMFER

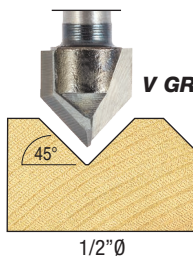

V GROOVE

GUIDED COVE

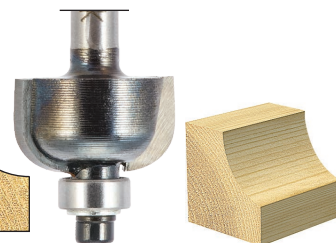
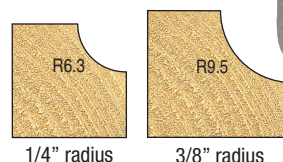

GUIDED TRIMMER

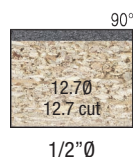

GUIDED REBATER

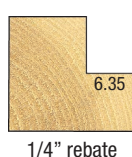

KEYHOLE

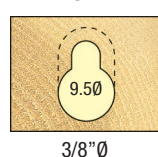

PIERCE & TRIM

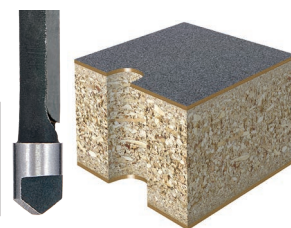
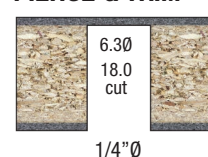

CORE BOX

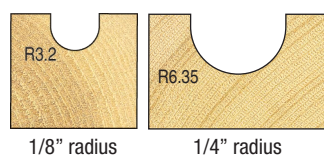

OVOLO PANEL

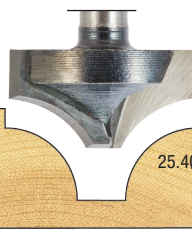
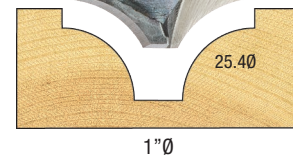

GUIDED ROMAN OGEE

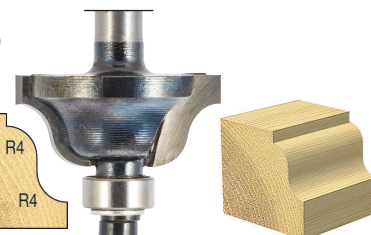
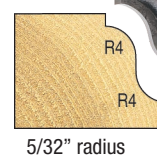

STAFF BEAD

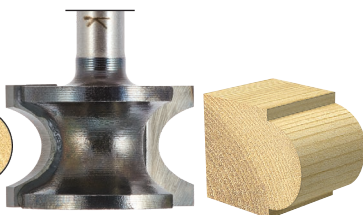
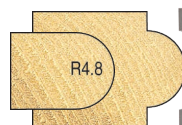

HINGE RECESS

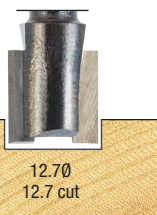
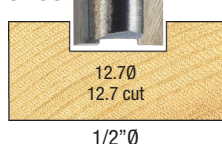

DOVETAIL

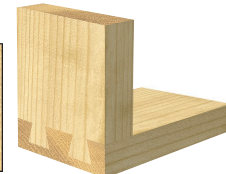
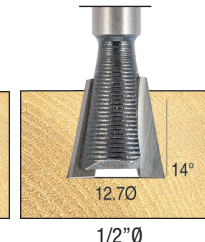
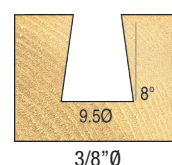

1/4" SHANK 30 PIECE SET

TCT
TUNGSTEN
CARBIDE
TIPPED

This set contains a selection of the most widely used bits for decorative and professional woodworking.

- Suitable for grooving, profiling and moulding.
- Includes seven straights from 5mm to 20mm diameter and fifteen bearing guided bits for straight and shaped work.
- Use on softwoods, hardwoods, MDF and plywood.
- Excellent value for money.



U*SET/SS31X1/4TC

TWO FLUTE

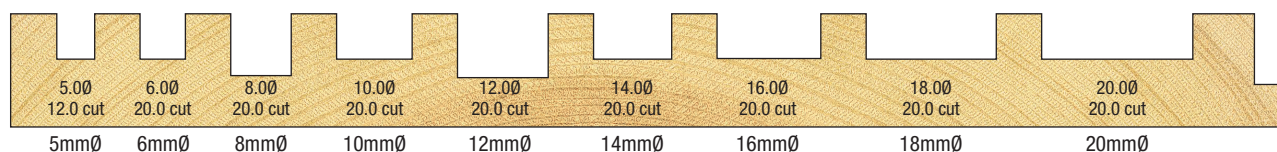

GUIDED TRIMMER

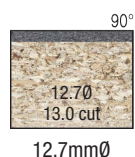

GUIDED REBATER

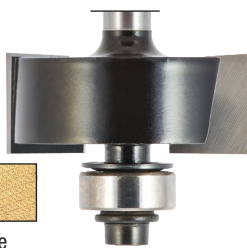
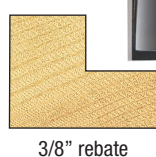

GUIDED CHAMFER

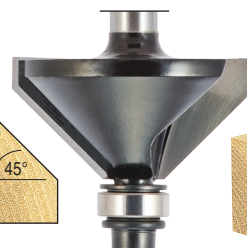
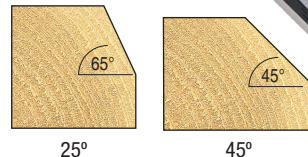

GUIDED COVE

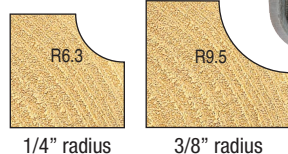

GUIDED ROUND OVER

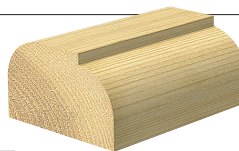
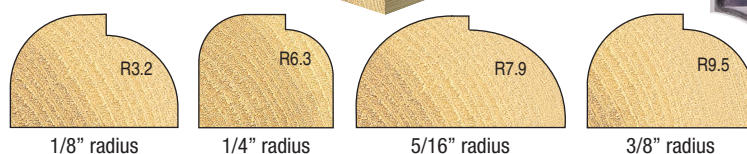

'V' GROOVE

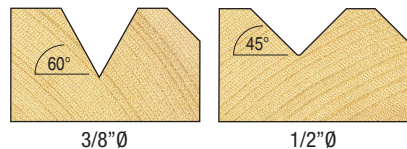

CORE BOX

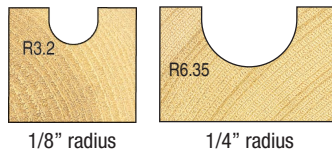

CLASSIC PANEL

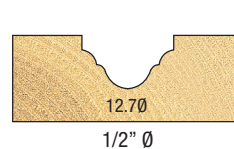

GUIDED OVOLO

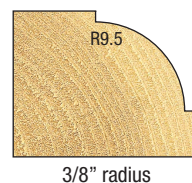
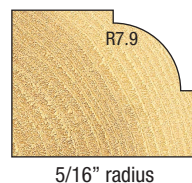
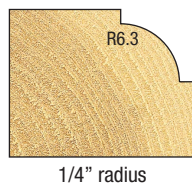
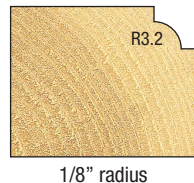

ROMAN OGEE

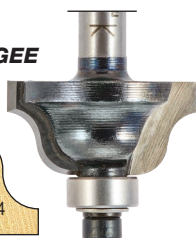
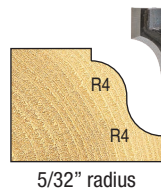

DOVETAIL

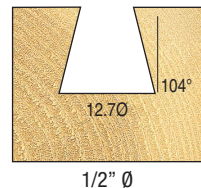

1/2" SHANK 35 PIECE SET

This set contains a concise selection of the most widely used bits for decorative and professional woodworking.

- Suitable for grooving, profiling and moulding.
- Set includes seven straights from 3.2mm to 19mm diameter and twenty-one bearing guided bits for straight and shaped work.
- Use on softwoods, hardwoods, MDF and plywood.
- Excellent value for money.

U*SET/SS35X1/2TC

TCT
TUNGSTEN
CARBIDE
TIPPED

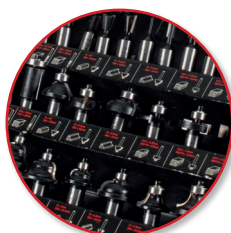

Bits tilt up for choosing and easy access.



Grooving with a two flute.



Ogee bit fitted in a router.



Rounding over a mould.

SINGLE FLUTE

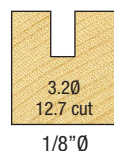

TWO FLUTE

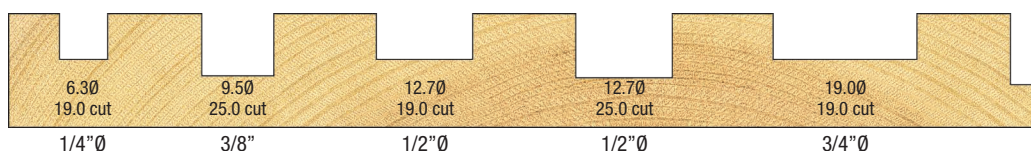

HINGE RECESS

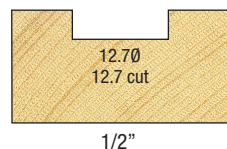

GUIDED CHAMFER

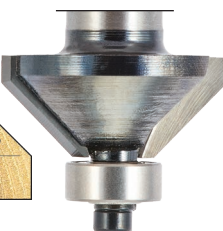
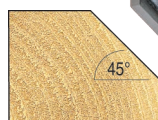

GUIDED TRIMMER

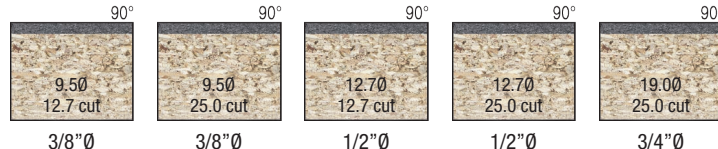

GUIDED COVE

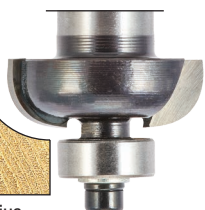
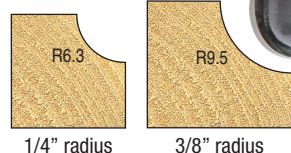

PIERCE & TRIM

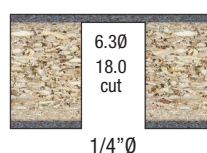

GUIDED ROUND OVER

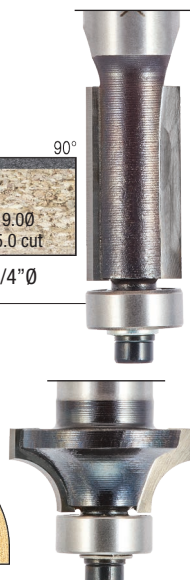
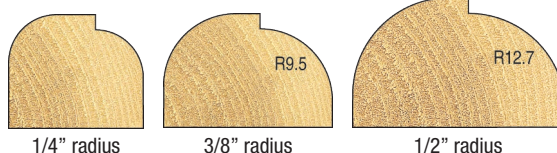



GUIDED ROMAN OGEE

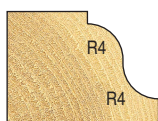

3/16" radius

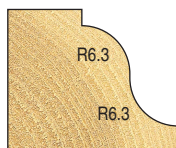

1/4" radius

GUIDED CLASSIC DECOR

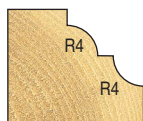

5/32" radius

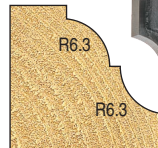

1/4" radius



WAVY EDGE



3/16" radius

'V' GROOVE



1/2" Ø

CORE BOX



1/8" radius



1/4" radius



LONG SERIES CORE BOX

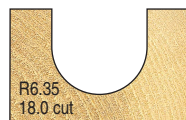

1/4" radius

GUIDED GROOVER

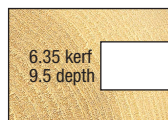

1/4" kerf

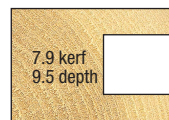

5/16" kerf

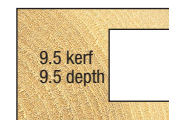

3/8" kerf

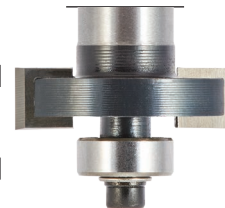

GUIDED OVOLO



1/2" radius



GUIDED CAVETTO



5/16" radius

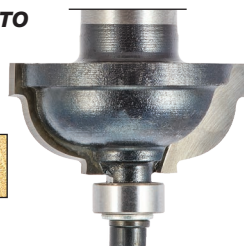

DOVETAIL

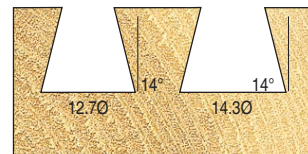

1/2" Ø

9/16" Ø



1/4" SHANK 50 PIECE SET

TCT
TUNGSTEN
CARBIDE
TIPPED

This 50 piece bits set contains a range of popular Tungsten Carbide Tipped bits for a variety of applications.

- Use on softwoods, hardwoods, Chipboard, Plywood and MDF.
- Includes 22 guided, 10 straight and 18 unguided router bits.
- Create 150 different profiles for a variety of applications.
- Excellent value for money.

U*SET/SS50 X1/4TC

SINGLE FLUTE

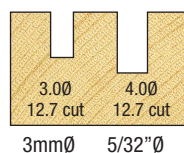

Grooving with a two flute.

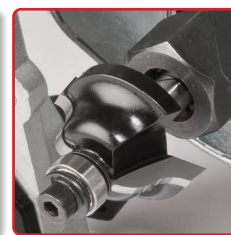

Ogee bit fitted in a router.

TWO FLUTE

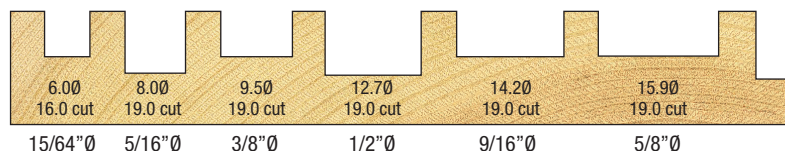

TWO FLUTE

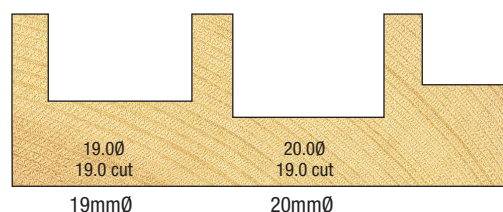

GUIDED TRIMMER

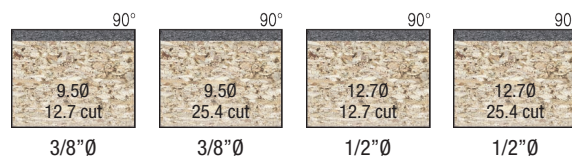

COMBINATION BEVEL

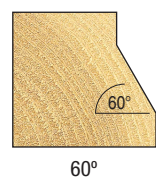

GUIDED CHAMFER

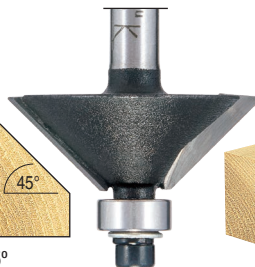
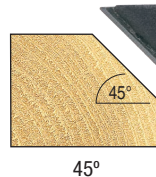
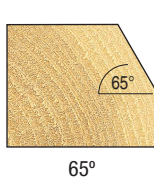

HINGE RECESS

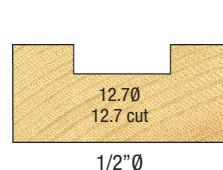

CLASSIC DECOR

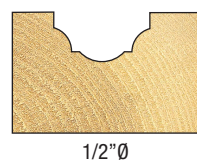

GUIDED COVE

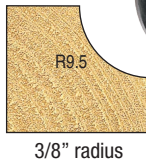

GUIDED REBATER

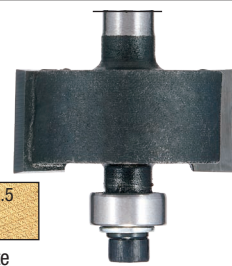
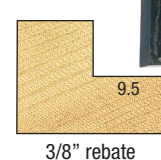

CORE BOX

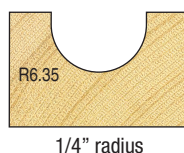
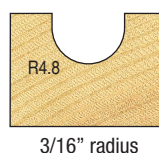

LONG SERIES CORE BOX

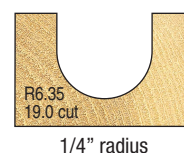
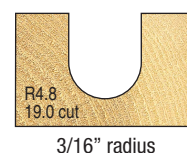

'V' GROOVE

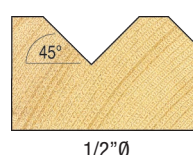
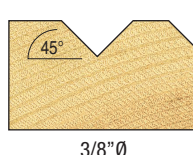
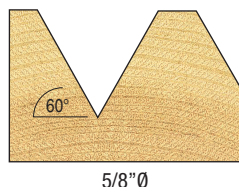
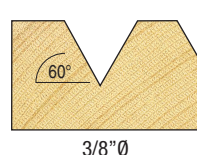



Rounding a chamfer.



Rounding over a mould.



PIERCE & TRIM

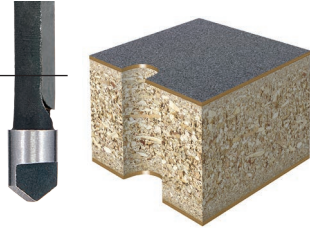

DOVETAIL

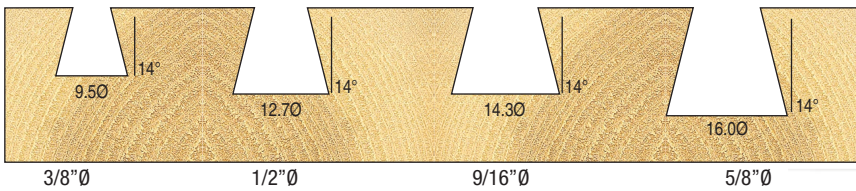

KEYHOLE

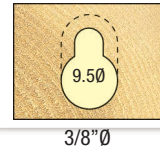

GUIDED ROUND OVER

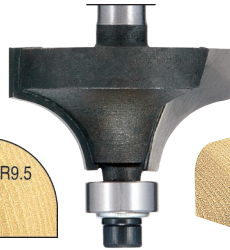
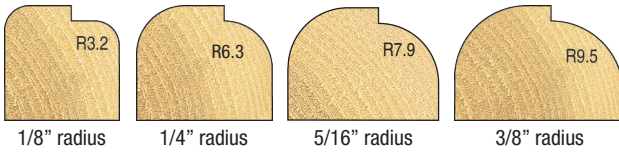

GUIDED CAVETTO

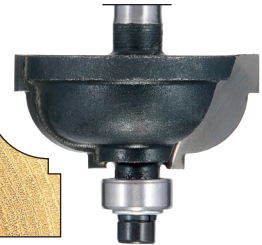
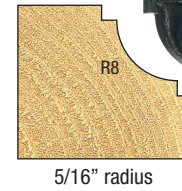

GUIDED OVOLO

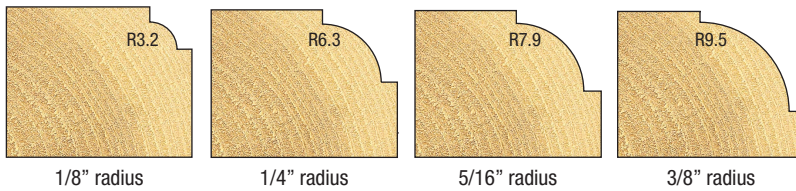

GUIDED ROMAN OGEE

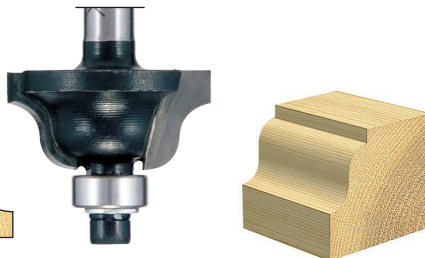
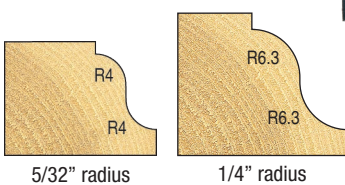

GUIDED GROOVER

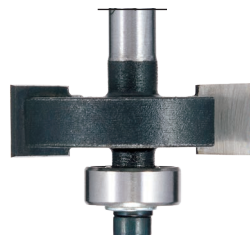
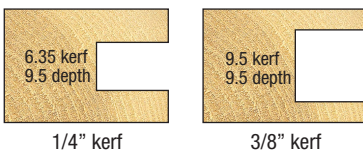

Profile dimensions in mm



DIAMOND SHARPENING SOLUTIONS

5
YEARS
GUARANTEE

A precision range of quality diamond whetstones for all your sharpening needs.

- Double-sided stones.
- Suitable for all Carbide and HSS hand tools.
- Woodworking, turning, carving, gardening and domestic.
- 'Excellence in Engineering' award.
- Unprecedented five year guarantee.



TIP

Use little pressure, let the diamond do the work, use the weight of the tool only on the surface of the stones.

TECHNICAL INFORMATION

CONSTRUCTION

Monocrystalline micronized diamonds are electroplated onto a precision pre-ground substrate. Electroplating produces very durable products, hence an unprecedented 5 year warranty. The following micron sizes of diamond have been chosen as the optimum for performance of the great variety of hand tools that can be sharpened using this range. The diamond is set into nickel, 2/3 buried and 1/3 exposed (locked in like an iceberg), thus the 1000 grit surface, 15 micron has a sharpening medium of 5 micron.



EXTRA FINE 15 Micron/1000 Grit

1000 grit is perfect for producing razor/polished edges with a very fast speed of cut. Ideal for carvers, cabinet makers, hunting knives, all fine woodworking.



FINE 25 Micron/600 Grit

600 grit is the most suitable grade for general fine sharpening. Ideal for Carbide router bits, turning tool inserts and circular sawblades.



COARSE 50 Micron/300 Grit

300 grit has been chosen to optimise the speed of cut for large stock removal. It is an ideal grit size for flattening the backs of chisels and plane blades. Also the popular choice for general joinery/site work and several applications in the woodturning industry. Ideal for all HSS.

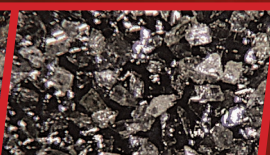

EXTRA COARSE 70 Micron/180 Grit

180 grit is made for rapid stock removal. Ideal for flattening waterstones, planer blades and chisels, re-shouldering knives, and taking nicks out of edges.

DOUBLE-SIDED SLIP STONES

APPLICATIONS:

- General Joinery
- Cabinet Making
- Turning
- Carving
- Pruners
- Loppers
- Shears
- Axes
- Budding Knives
- Scissors
- Kitchen Knives
- Serrated
- Straight Blades
- Hunting Knives

3" CREDIT CARD STONES

A double-sided coarse/extra coarse 300/180 grit credit card size stone. Ideal for woodturners, on-site chisel flattening and hunters in the field.

Ref.

U*DWS/CC/CX

Size: 3-1/4" x 2" x 1/16", 300/180 Grit

A double-sided coarse/extra coarse 300/180 grit credit card size stone. Ideal for woodturners, on-site chisel flattening and hunters in the field.

Ref.

U*DWS/CC/CX

Size: 3-1/4" x 2" x 1/16", 300/180 Grit

A double-sided fine/coarse 600/300 grit stone, with grit sizes for easy identification. Ideal for Carbide & HSS shaped router bits, Carbide inserts, woodturning tools and general woodworking. Supplied in a wallet.

Ref.

U*DWS/CC/FC

Size: 3-1/4" x 2" x 1/16", 600/300 Grit

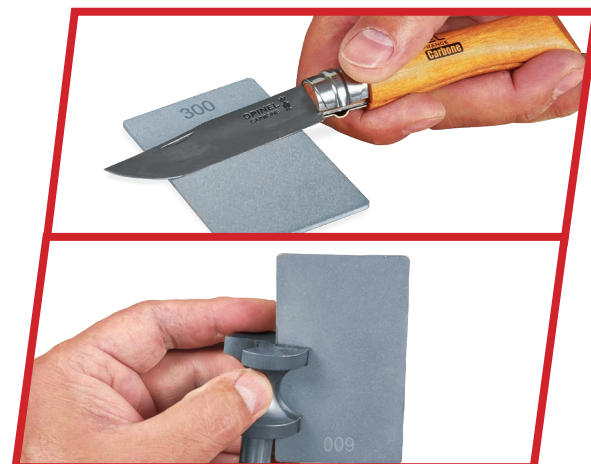

3" CARVERS STONE

Almost twice as thick as standard credit card stones. Double-sided extra fine/fine 1000/600 grit stone has grit sizes for easy identification. Ideal for carving tools, Carbide and very fine edge sharpening.

Ref.

U*DWS/CS/FF

Size: 3-1/4" x 2" x 1/16"
1000/600 Grit

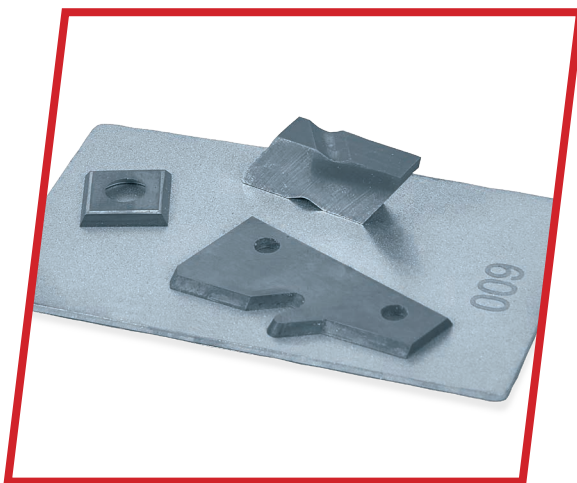

DIAMOND SHARPENING

PRECISION DIAMOND BENCH STONES

Monocrystalline diamonds electroplated onto a precision ground substrate.

- Fine grit is suitable for achieving a razor, shaving edge in seconds. Ideal for cabinet making and fine woodworking.
- Coarse grit re-shapes and re-hones damaged edges, ideal for site work, general joinery and flattening chisels and plane blades.
- Precision flatness enables the sharpening of Carbide and HSS inserts, spindle knives and clipper blades.
- Supplied with non-slip mat and cleaning block. U*DWS/B7/FC supplied in fabric tool holder.
- Use with Trend lapping fluid.

DOUBLE-SIDED BENCH STONES

EXTRA FINE SIDE

1000 Grit 15 Micron

COARSE SIDE

300 Grit 50 Micron

Ref.

U*DWS/W6/FC

Size: 6" x 2" x 5/16"

Ref.

U*DWS/B7/FC

Size: 7" x 2.5" x 3/8"

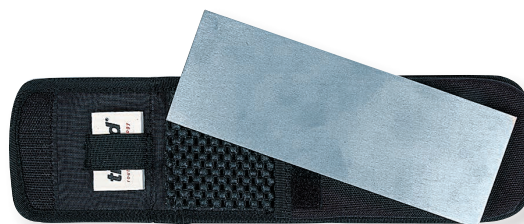
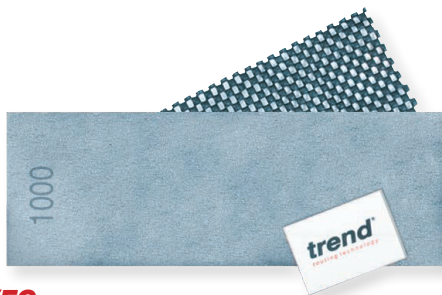

CLASSIC PROFESSIONAL BENCH STONES

DOUBLE-SIDED WORKSHOP STONE

Unique combination of surfaces for optimum performance.

- Precision flatness, with pre-ground substrate.
- Prevents 'snagging' in holes when sharpening small or pointed tooling.
- Clearance channels on the coarse surface disperses the residue faster when heavy stock removal is required thus increasing the speed of cut.
- Continuous diamond fine surface ideal for fine honing of knives, plane blades and chisels.
- Supplied in fabric tool holder with non-slip mat and cleaning block.

EXTRA FINE SIDE

1000 Grit 15 Micron

COARSE SIDE

300 Grit 50 Micron

Ref.

U*DWS/CP8/FC

Size: 8" x 3" x 5/16"

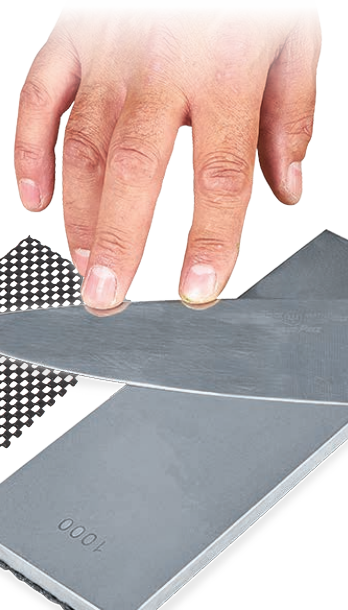

WARNING - California Proposition 65 - www.P65Warnings.ca.gov - See page 2 for more information

trend 25
tool technology

DIAMOND FILES

SHARPENING SOLUTIONS FOR ALL TOOLING USED BY PROFESSIONALS AND HOBBYISTS ALIKE:



- | | | | |
|-----------------|-------------------|-------------------|-----------|
| • Shaped Tools | • Sawblades | • Scrapers | • Loppers |
| • Gouges | • Carbide Inserts | • Hoof Knives | • Knives |
| • Forstner Bits | • Scissors | • Pruners | • Axes |
| • Router Bits | • Skews | • Serrated Blades | |

6" TAPERED FILE

Flat top and convex back tapered file.

- Fine 600 grit (25 micron) monocrystalline diamond.
- For all hand tools.
- Ideal for garden and domestic applications.

Ref.

U*DWS/TF6/F

Size: 10-5/8" overall length
with 6" diamond length.



3" FINE TAPERED FILE

**A versatile half round/
flat tapered file for
woodworking, gardening
and domestic tooling.**

- Precision quality taper file.
- Fine 400 grit (35 micron) monocrystalline diamond.
- Split plastic contoured hand-grip which is pinned each side of blade.
- Designed for woodturning and carving tools. Sharpens Carbide Tipped tooling in seconds.

Ref.

U*DWS/TF3/F

Size: 6" overall length with 3" diamond
length thickness 3/32" to 1/16".



3" MINI FINE TAPERED FILE

**Precision quality
taper file.**

- Fine 600 grit (25 micron monocrystalline diamond).
- Split plastic contoured hand-grip which is pinned either side of blade.
- Suitable for sharpening forstner bits, rotary carving, woodturning and carving tools. Unique size allows access to difficult sharpening problems.

Ref.

U*DWS/TF3M/F

Size: 6" overall length with 3" diamond length, thickness 1/8" to 1/16".

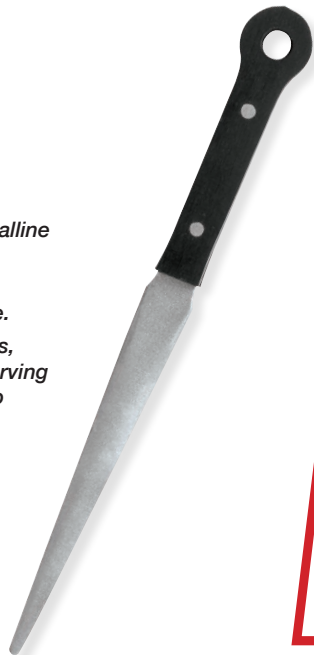

PRECISION NEEDLE FILES

**Four precision quality electroplated
monocrystalline diamond files.**

- Fine 600 grit.
- Diamond coverage 3" (overall length 6-5/16").
- Supplied to the Aerospace industry.
- Ideal for wood, metals, plastics, glass and ceramics.

Ref.

U*DWS/NFPK/F

Flat

Half round
taper
flat

Triangular
taper

Round
taper

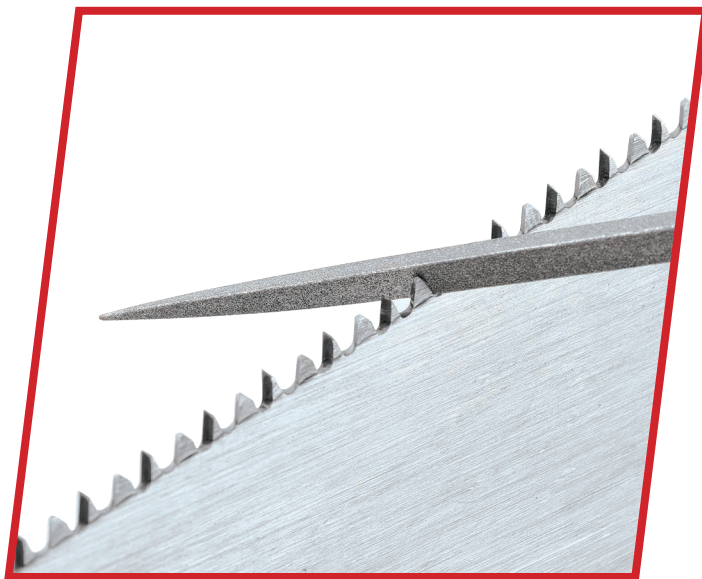

TOOL AND BIT CLEANER 532ml

Spray-on resin and pitch remover.

- Simply spray on wipe off.
- Ideal for sawblades, router cutters, planer blades, files, wrenches and drill bits etc.
- Excellent lubricant. Provides rust and corrosion protection.
- Has unique properties which break the molecular bond and lifts the dirt from the tool as opposed to eating away the dirt like citrus cleaners and other chemicals.
- Industrial strength cleaner that increases tool life.
- Non-flammable.
- Supplied in pump action dispenser.

Product References

CLEAN/500

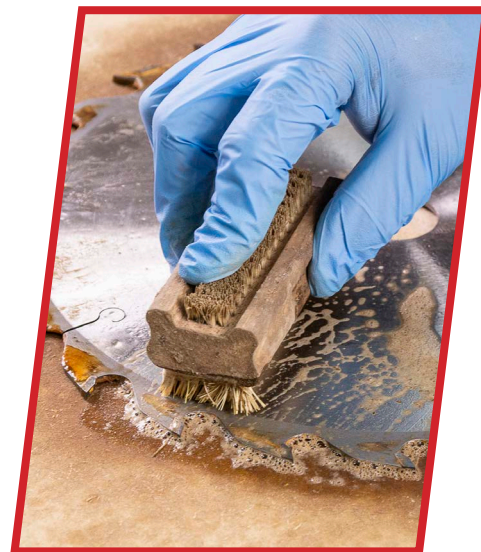

DIAMOND KITS

ULTIMATE BENCH STONE SHARPENING KIT

NEW

The ultimate sharpening and maintenance kit for kitchen, hunting and pocket knives. It includes two 8" x 3" double-sided bench stones which employ four diamond grits (180, 300, 600, 1000 grits). Supplied in an aluminum carry case.

INCLUDES

- U*DWS/CP8/FC** 8" x 3" extra fine/coarse double-sided bench stone
- U*DWS/CP8/FX** 8" x 3" fine/extra coarse double-sided bench stone
- U*DWS/LF/100** Lapping fluid 3.4 fl.oz
- U*DWS/HP/US** Honing compound bar
- U*DWS/NM/W8** Non-slip mat
- U*DWS/HP/LS** Leather strop
- U*DWS/CB/A** Cleaning block
- U*BOOK/DWS** Booklet

Ref.
U*DWS/KIT/E



HONING & POLISHING KIT

Ideal for chisels, plane blades and all hand tools.

Ref.
U*DWS/KIT/B

INCLUDES

- U*DWS/CP8/FC** 8" x 3" bench stone
- U*DWS/HG/SET** Honing guide set
- U*DWS/LF/100** Lapping fluid
- U*DWS/HP/LS** Leather strop
- U*DWS/HP/US** Honing compound bar
- U*DWS/NM/W8** Non-slip mat
- U*DWS/CB/A** Cleaning block
- U*BOOK/DWS** Booklet



COMPLETE SHARPENING KIT

For forstner bits, turning tools, router bits, chisels, Carbide & HSS inserts.

Ref.
U*DWS/KIT/C

INCLUDES

- U*DWS/CC/FC** Credit card stone with non-slip mat.
- U*DWS/TF3M/F** 3" Mini taper file
- U*DWS/LF/100** Lapping fluid
- U*DWS/CB/A** Cleaning block
- U*BOOK/DWS** Booklet



CREDIT CARD SHARPENER KIT

Includes two heavy duty stones which offer 180, 300, 600 & 1000 grit.

Ref.
U*DWS/KIT/D

INCLUDES

- U*DWS/CC/CX** Credit card stone, coarse 300 grit and extra coarse 180 grit with non-slip mat.
- U*DWS/CS/FF** Credit card stone, extra fine 1000 grit and fine 600 grit.
- U*DWS/LF/100** Lapping fluid
- U*DWS/CB/A** Cleaning block
- U*BOOK/DWS** Booklet



ESSENTIAL SHARPENING KIT

NEW

Everything needed to flatten, hone and polish plane irons, knives and chisels. Supplied in a heavy duty aluminum carrying case.

Ref.
U*DWS/KIT/H

INCLUDES

- U*DWS/CP8/FC** 8" x 3" extra fine/coarse double-sided bench stone.
- U*DWS/HP/LS** Leather strop
- U*DWS/LF/100** Lapping fluid
- U*DWS/MP/40** Mirror paste
- U*DWS/CB/A** Cleaning block



SHARPENING ACCESSORIES

TREND LAPPING FLUID

Use with quality diamond abrasive products.

- A petroleum based synthetic lubricant to be used with diamond compounds.
- An advanced lubricant, with penetrating qualities and oil/water solubility, not only increases the cutting action, but assures superior lubrication of every diamond particle throughout the honing process and greatly reduces the risk of rusting.
- Ideal for cleaning and reduces the risk of clogging in CBN wheels.



Ref.s
U*DWS/LF/100 3.4 fl.oz
U*DWS/LF/250 8.5 fl.oz
U*DWS/LF/500 17 fl.oz

Cleaning Block for all stones
U*DWS/CB/A



HONING GUIDE

Set the perfect angle for chisels and plane blades.

- Easy to set, complete with the unique angle setting plate which is preset for 25°, 30°, 35° and 40° angles.
- Clamps from the sides to keep tool square.
- Clamps from 3/8" to 1-1/4" bevel edge chisels and up to 2-3/8" wide plane irons.
- Maximum tool thickness 0.275".



Ref.
U*DWS/HG/SET



MIRROR PASTE

NEW

Micro fine abrasive paste for a mirror finish on blades.

- Puts a polished edge on carving tools, chisels, plane blades and knives.
- Offers a mirror finish on cutting edges for clean cuts.



Ref.
U*DWS/MP/40
 1.2 fl.oz
 2-3 micron,
 8000 - 10000 grit



MIRROR PASTE & STROP KIT

NEW

Achieve a mirror finish on all your workshop tools.

- Apply mirror paste to strop, rub to absorb and then stroke edge until polished finish.



Ref.
U*DWS/MP/KIT

INCLUDES
U*DWS/MP/40
 Mirror paste
U*DWS/HP/LS
 Leather strop



HONING COMPOUND BAR & STROP KIT

Achieve a polished finish on chisels and plane irons.

- Used to give a highly polished finish to a sharpened cutting edge.



Ref.
U*DWS/HP/KIT

INCLUDES
U*DWS/HP/US
 Honing compound bar
U*DWS/HP/LS
 Leather strop

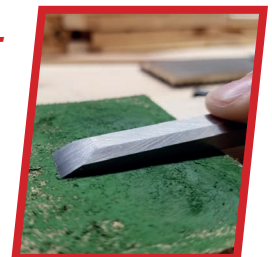

DOOR HANGING

AD AnyDoor

NEW

9' BUTT HINGE TEMPLATE KIT

Fully adjustable, modular router jig designed to quickly and accurately recess square and radius (5/8" & 1/4") hinges in timber doors & frames. Accommodates all hinge sizes, hinge positions and door heights.



Any Door Size*

1/8" (3.0mm) Steel End Plate
allows the jig to fit both door and frame with minimal adjustment.

Adjustable Quick-Release Aperture Blocks
Feature Trend's tool-free, patented* thumb-turn locking mechanism for fast, accurate hinge positioning.



Any Hinge Size*

Twin-Rail System**
Provides unlimited hinge positions within the rail, making the jig perfect for both new and replacement installations.



Any Hinge Position*

1" (25mm) Rail Depth
Allows jig to be used against fixed door stops.

*See specifications for limitations

U*H/JIG/D9

**Patent Pending: GB2210813.8



R1/4"

90°

R5/8"

6'6"
(78")

6'8"
(80")

7'0"
(84")

8'0"
(96")

9'0"
(108")

HOW DOES ANYDOOR WORK?



Set the length using hinge as a pattern

Set the width using the hinge as a pattern

Set the depth using the hinge as pattern

Rout the frame

Rout the door

TREND COMPLETE DOOR INSTALLATION KIT INCLUDES:**U*H/JIG/D/B1 BUNDLE****AD AnyDoor****9' BUTT HINGE TEMPLATE KIT****x1****U*H/JIG/D9****DOOR
LIFTER****x1****U*D/LIFT/A****DOOR
STAND****x1****U*D/STAND/A****PRO
ROUTER
BIT****x1****U*3/80LX1/4TC****TREND ULTIMATE DOOR INSTALLATION KIT INCLUDES:****U*H/JIG/D/B1 BUNDLE****AD AnyDoor****9' BUTT HINGE TEMPLATE KIT****x1****U*H/JIG/D9****DOOR
LIFTER****x1****U*D/LIFT/A****DOOR
STAND****x1****U*D/STAND/A****PRO
ROUTER
BIT****x1****U*3/80LX1/4TC****T1 PLUNGE &
TRIM ROUTER****x1****U*T1EPS**

DOOR HANGING PROFESSIONAL LOCK JIG



A site-tough routing jig with interchangeable templates to cut lock & face-plate recesses in timber doors. Steel construction and tool-free setup deliver speed and accuracy. Ideal for all popular mortise sash locks, dead locks and latches.





Centering Template

*Ensures jig
is perfectly
positioned on
any door.*



Steel Construction

*For maximum
strength, durability
and accuracy.*

LOCK/JIG Look-up Chart			
	Door & Frame	4" x 1"	Template
	Heavy Duty (HD)	2-1/2" x 1-1/2"	HD-A
	Heavy Duty (HD)	2-1/2" x 1-1/2"	HD-B
	Heavy Duty (HD)	2-1/2" x 1-1/2"	HD-C
	Door & Frame	4" x 1"	Template
	Heavy Duty (HD)	2-1/2" x 1-1/2"	HD-A
	Heavy Duty (HD)	2-1/2" x 1-1/2"	HD-B
	Heavy Duty (HD)	2-1/2" x 1-1/2"	HD-C
	Door & Frame	4" x 1"	Template
	Heavy Duty (HD)	2-1/2" x 1-1/2"	HD-A
	Heavy Duty (HD)	2-1/2" x 1-1/2"	HD-B
	Heavy Duty (HD)	2-1/2" x 1-1/2"	HD-C
	Door & Frame	4" x 1"	Template
	Heavy Duty (HD)	2-1/2" x 1-1/2"	HD-A
	Heavy Duty (HD)	2-1/2" x 1-1/2"	HD-B
	Heavy Duty (HD)	2-1/2" x 1-1/2"	HD-C

Reference Chart

Provides quick reference between templates and lock sizes.



Thumb-Turn Quick-Release Clamps

***With non-marring pads,
secure the jig quickly
and easily.***

Full-Length Fence

Secured with three locking levers adjusts the jig quickly and securely for all doors between 1-11/32" and 2-9/32" thick.

Height Spacers

Can be adjusted to accommodate different guide bush spigots.

CONTRACTOR LARGE LOCK JIG

*For routing the faceplate and mortise
for larger locks quickly and accurately.*

- Suitable for two sizes of Baldwin locks with faceplate sizes 1-1/4" x 8" or 1" x 8" and mortise sizes 1" x 5-23/32" or 7/8" x 5-23/32".
- Fast, clean & accurate results on doors 1-5/16 inch to 2-1/4 inch thick, even in hardwood.
- Adaptor plate included to allow smaller templates to be fitted (as supplied with standard LOCK/JIG).
- An auger bit and drill is required to complete deep mortises.
- Includes 15/32 inch diameter 1/2 inch shank TCT router bit and 1-3/16 inch screw-on style guide bush.
- Jig requires a router with 3-1/8 inch plunge.



ACCESSORIES

DOOR STAND

Secures doors horizontally when cutting hinge recesses and mortice locks, and vertically to assist with door hanging. Ideal for use with Trend Hinge and Lock jigs.

 **All-Metal Construction**
supports doors up to 127.8lbs

 **Wide Stability Brace**
prevents Unwanted Movement

 **Non-Scratch**
Base

 **Thumb-Turn Clamp**
(1-1/4" to 2-5/32")

U*D/STAND/A



Support for routing hinges & mortises.



Support to assist fitting door to frame or lining.

CORNER CHISEL

To quickly square up rounded corners when using lock and hinge jigs.

 **Spring Loaded HSS Anvil**
for a Sharp Cut & Long Life

 **Ideal for Squaring Hinge Recesses in Door Frames**

 **Light Weight**
Aluminum Body Design

 **Can be**
Resharpened

U*C/CHISEL



Before



After

EASYSCRIBE®

A patented handheld tool for accurate scribing and fitting of architrave, skirting, doors, worktops, plinths, flooring, window boards, wall panelling, tiles and more. Ideal for working with uneven and irregular floors, walls and door frames.

 **1/32" Marking Line**
for Precision & Accuracy

 **1-15/16" Guide Plate**
for Narrow Gaps

 **3/64" to 1-9/16"**
Adjustment Wheel

 **Flat Base ensures**
a Consistent Scribe

U*E/SCRIBE



DOOR CLAMP

Holds doors in-situ to assist with handle, lock and latch fitting

 **Quick-Release**
Ratcheting Mechanism

 **Non-Marring**
Clamp Pad

 **Universal**
Design (2-3/16")

 **Protective**
Rubber Base

U*D/CLAMP/A



DOOR LIFTER

Foot operated device to raise doors into position when fitting hinges to a door frame

 **Purpose-Built Cam Design**
Lifts Doors Up To 1-1/2"

 **Robust Construction**
Lifts Doors Up To 240lbs

 **Foot**
Operated

U*D/LIFT/A



CABINETRY RANGE

CABINET HARDWARE DRILLING JIG

NEW

A versatile jig for the repetitive installation of handles on a wide variety of door and drawer fronts.

 **Self-Centring Scales**

 **Reversible Design**

 **Protective Rubber Over-Mould**

 **5/32" Tool-Steel Drilling Guides**

 **Quick 3-Stage Setup in Seconds**

U*CAB/JIG/A



1-3/8" CONCEALED CABINET HINGE JIG

NEW

A precision drilling jig for installing concealed cabinet hinges accurately and quickly.

 **In-built Depth Stop**

 **1/8" 5/32" 13/64" 15/64" Hinge Inset Positions**

 **25/64" to 33/64" Hole Depth Range**

 **Pilot Hole Plate**

 **Pin Guide System**

U*CAB/JIG/B

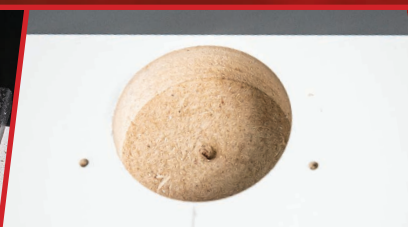
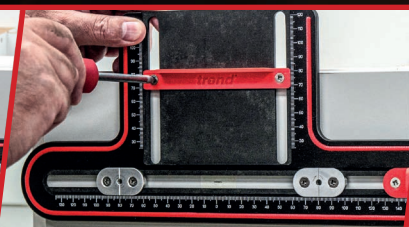

POCKET HOLE JIG RANGE

PERFECT JOINTS IN MINUTES

For fast, repeatable and accurate joining of timber and plywood look no further than the Pocket Hole Jig range from Trend. A must have tool whether a beginner or expert in carpentry.

 **Strong Joints**

 **Fast Set-Up**

 **Multiple Applications**



SQUARE CORNER JOINTS



MITRE FRAME CORNER JOINTS



CURVE JOINTS



EDGE TO EDGE JOINTS



POST & RAIL JOINTS



T JOINTS



POCKET HOLE JIG
U*PH/JIG



PRO POCKET HOLE JIG
U*PH/JIG/AK



3 IN 1 POCKET HOLE JIG
U*PH/JIG/BK



TWIN POCKET HOLE JIG
U*PH/JIG/C



SINGLE POCKET HOLE JIG
U*PH/JIG/BS



Narrow repairs and strengthening applications in confined spaces



Small construction projects such as benches, tables and chairs



Large construction projects such as cabinets, bookcases and workbenches



Create a multitude of joints like Mitred Frames, Apron Rails, Coopered Joints and more

NEW

UNIVERSAL COUNTERSINK

- Clamps onto any drill between 1/8" and 9/32" in diameter.
- For wood and man-made boards.
- By flipping the countersink it can be used as a non-cutting depth stop.
- The drill passes through the body of the countersink and is secured by two hex screws which clamp the countersink onto the drill at the required position.

- ▲ Ensure flutes of drill are aligned with flutes of countersink.
- ▲ Not suitable for production applications or for metals. Not for use with routers.

TCT



Fully adjustable from 3mm to 9/32".

TCT for long life.

Can be flipped 180° to act as a depth stop.

Drill bit not included.

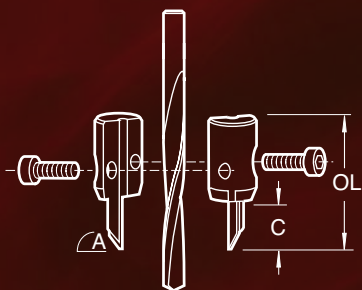

Ref.	A Deg.	C inch	OL inch
U*UNI/CS	45°	15/32	1-1/4

SPARE PART

Hex key & two screws **U*SP-O**

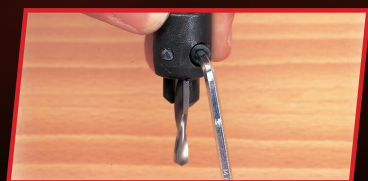

LOOSE TENONS

Beechwood tenons for strong and precise timber jointing



Festool® Dimension Tolerances



Full Length Glue Grooves



User Friendly Pack Size



5/32" x 25/32"

U*TEN/4X20/100



13/64" x 1-3/16"

U*TEN/5X30/100



15/64" x 1-3/16"*
15/64" x 1-37/64"

U*TEN/6X30/100



5/16" x 1-37/64"

U*TEN/8X40/50
U*TEN/8X50/50



25/64" x 1-31/32"

U*TEN/10X50/50

JOINTING BISCUITS

Biscuit jointing has proven to be one of the strongest, fastest, safest and most accurate ways to join hardwoods and softwoods, plywood, composition board etc. Compared to dowelling, biscuit jointing is faster and more precise. The biscuits are made of die-cut beech which expands when in contact with a woodworking adhesive eg. PVA glue.

For certified biscuits see our website.



No. 0

For board thickness
5/16" - 15/32"
Size: 1-7/8" x 39/64" x 5/32"
U*BSC/0/100



No. 10

For board thickness
33/64" - 45/64"
Size: 2-3/32" x 3/4" x 5/32"
U*BSC/10/100



No. 20

For board thickness 3/4"+
Size: 2-23/64" x 29/32"
x 5/32"
U*BSC/20/100



No. 0, 10 & 20

Qty No. 0 x 30, No. 10 x 30
& No. 20 x 40
U*BSC/MIX/100



VARIJIG SYSTEM

VARIJIG FRAME SYSTEM

Adjustable frame and guide for use with a router.

- Adjustable frame for rectangles and squares.
- Allows a router to cut recesses, slots, face panel moulds etc. Can also be used to create panel doors.
- Four lengths of 27-1/2" extrusion with dual metric/imperial measuring scales.
- Working area 23-1/2" x 23-1/2".
- Cross cut accuracy to 5 thou.
A square is required to square frame before use.
- Use with a guide bush with minimum 5/16" spigot length, or use Unibase as guide.

Ref.
U*VARIJIG

Router not included.

INCLUDES

- 4 x Alloy extrusions with scales
- 4 x Corner brackets
- 1 x Anti-tilt shoe
- 1 x Anti-tilt shoe fixing screw

REPLACEMENT PARTS

Frame jointing kit
Set of four corner jointing brackets.

Ref.
U*VJS/FJK

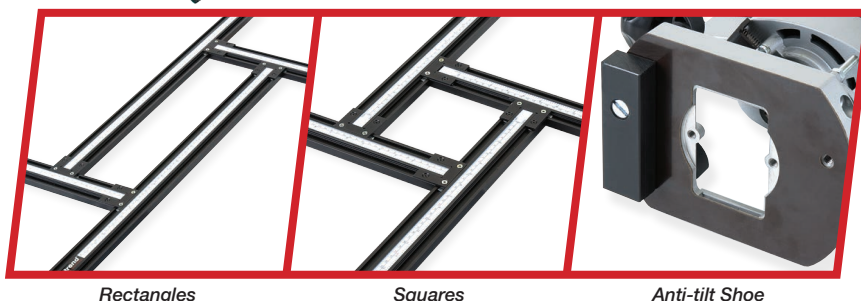

Rectangles

Squares

Anti-tilt Shoe

VARIJIG 100" STRAIGHT GUIDE

For guiding routers, circular saws and jigsaws.

- Two lengths of extrusion with jointing piece to give maximum working length of 100" (2540mm). Reduced length for easier transport and storage.
- Clamps can slide along each extrusion.
- Maximum material clamping thickness 1-1/4".
- Adjustable friction washer on clamps prevent clamp from sliding too freely.
- One extrusion has dual metric/imperial scale.
- Can be combined with Varijig parts.

Ref.
U*VJS/G/100

INCLUDES

- 1 x 56" Alloy extrusion with scale
- 1 x 56" Alloy extrusion
- 1 x Connecting block
- 1 x Hex key 4mm (5/32")
- 2 x 1-1/4" Sliding friction clamps



Crosscutting

VARIJIG EXTRA LONG PIVOT CLAMPS

Pair of pivoting sliding friction clamps with 2" clamping thickness.

- 360 degree clamp rotates to allow the pad of the clamp to be secured firmly to the workpiece.
- The clamp can be used with the Varijig system including the Varijig set, straight guides and angle guide.
- Aluminum body with soft pads to prevent marring of component.
- Friction lock design, so they can be positioned in extrusion without sliding out end when clamp lifted up.

Ref.: **U*VJS/PCK/L**

OPTIONAL ACCESSORIES FOR VARIJIG SYSTEM

Clamp kits (Fit to extrusions on varijig system)
Pair of sliding friction clamps with 1-1/4" clamping thickness.
U*VJS/CK

Pair of long sliding friction clamps with 2" clamping thickness.
U*VJS/CK/L

Connecting block kit
Jointing block for extrusions.
U*VJS/G/CB

Recommended 1-3/16" guide bush
Euro Style with extra long 3/8" spigot
for U*VJS/TG/JIG or U*VARIJIG.
U*GB30/A

Screw-on Style.
U*GB/US/30

Universal sub-base
Certain makes & models of router will require a Unibase
to accept the Euro Style guide bush Ref. U*GB30/A.
U*UNIBASE

VARIJIG SELF CLAMPING GUIDES

Self clamping, straight line clamp guides that use the Varijig low profile extrusion.

- For accurate guiding of routers, saws and jigsaws.
- Low profile extrusion with integral clamping of workpiece, double locking mechanism and two full length T-slots.
- Common Varijig extrusion to 24 inch (610mm), 36 inch (915mm) and 50 inch (1270mm) Clamp Guides.
- Metric and imperial sliding scale.
- Extrusion profile 5/8 inch (16mm) high x 2-1/8 inch (54mm) wide.
- Ref. VJS/CG/PRO8 is an extra wide clamp 5 inch (127mm) with four T-slots. Ideal for large sheet material, clamps up to 96 inches (2.44 metres).
- Jaws have fixing holes for accessories.

Ref.s

U*VJS/CG/24 24" (610mm)

U*VJS/CG/36 36" (915mm)

U*VJS/CG/50 50" (1,270mm)



BEARINGS 3/16" BORE

Bearings are shielded to prevent penetration of dust and grease packed for life.

- They should not be cleaned with solvent or lubricated as this will dissolve the grease and cause premature failure.
- Scrape off any resin build-up.
- Always check the tightness of the fixing screw before using bit.



Ref.	OD mm	OD inch	ID mm	ID inch	T mm	T inch
U*B127A	12.7	1/2	4.76	3/16	4.76	3/16
U*B16A	15.9	5/8	4.76	3/16	4.76	3/16
U*B19A	19.05	3/4	4.76	3/16	4.76	3/16

COLLET EXTENSIONS

For use in router tables where there is limited router bit shank length available.

- Precision machined one-piece steel body with a 1/2" shank, fitted with a multi-slit spring steel collet and collet nut.
- Increases bit spindle length by 2".
- Maximum tool diameter 1-31/32". Requires 3/4" & 7/8" A/F spanners.

Ref.s:

U*CE/127127 Collet extension 1/2" shank & collet

U*CE/127635 Collet extension 1/4" shank & collet

U*CE/CNS/635 Collet & nut set 1/4"

U*CE/CNS/127 Collet & nut set 1/2"

U*CE/NUT Spare collet nut



SHELF SUPPORT TEMPLATE

Allows routing or drilling of 32mm "Euro" centre holes for 5mm diameter shelf supports.

- Made from clear plastic, with graduation scales.
- Adjustable clamping bar with two locking knobs.
- Can be used with MDF, timber and particle board.
- A Unibase may be required for certain makes and models of router.

Ref.

U*TEMP/SS/A

Size: 19-11/16" x 5-1/8" x 5/16"



INCLUDES

- 12 x Plain metal shelf supports
- 1 x Knurled repeat index pin
- 1 x 9.5mm guide bush



SHELF SUPPORTS

Metal

With rubber sleeve to protect glass.
Pin: 13/64"Ø (5mm) x 21/32"OL

U*SS/M5/12 (pack of 12)

Brass plated

Pin: 13/64"Ø 5mm x 29/32"OL
Load capacity 220.5lbs (100kg)

U*SS/B5/12 (pack of 12)

Plastic

Load capacity 220.5lbs (100kg)
U*SS/P5/12 (pack of 12)

SUITABLE TOOLS

5mmØ recommended Bit
CraftPro router drilling bit.

U*C174X1/4TC

Shelf support drill bit guide
A quick release shank lip and spur 5mm HSS drill bit guide, which when used with template will allow 5mm diameter blind holes to be drilled for shelf supports.

U*TEMP/SSD/5MM



ROUTER POD

A simple and effective accessory designed to keep your router in a safe upright position when not in use.

- Protects the cutter and guide bush.
- Gives fast, easy access when you are ready to rout.
- Stack double for extra long cutters.
- Anti-slip rubber feet for a secure grip.

Ref.

U*R/POD/A



MINI FLEXIBLE CURVE GUIDE

A mini size flexible guide that is used to make a pattern, allows a shape to be cut repeatedly with precision.

- Will produce round, segmental or elliptical arch shapes, curves and cutouts.
- Use with a router and bearing guided cutter or with a guide bush and unguided cutter.
- Flexible guide is screwed to a template with the fixing screws included.
- Template should be rough cut oversize prior to routing.
- For MDF boards up to 3/8 inch thick.
- An 5/16 inch user made spacer should be fitted to underside of router to keep router stable.

Ref.

U*CURV/8X500
U*CURV/8X1000



MEASURING & MARKING

DIGITAL LEVEL BOX

ANGLE SENSOR
TECHNOLOGY

Find the angle on a surface quickly and accurately. Ideal for table and mitre saws.

- Automatic LCD large backlight for easy reading.
- Measures in relative and absolute measurements.
- Working range of angle measurement $4 \times 90^\circ$.
- Automatic digital inversion for overhead measurements.
- Magnetic base for hands free use.
- Zero button to determine the angle change from initial measurement.



Ref.
U*DLB

SPECIFICATION

Read out accuracy for all angles $\pm 0.2^\circ$
 Resolution 0.1°
 Auto shutdown time 5 minutes
 Auto shutdown backlight 30 seconds
 Size $2-21/64" \times 2-21/64" \times 17/64"$
 Weight 2.9oz

INCLUDES

- 1 x AAA 1.5V Battery
- 1 x Fabric Pouch



Magnetic base

Large back light

MULTISCRIBE

A profile matching tool used to transfer contours from one shape to another and marks onto various materials.

- 15 functions including parallel scribe, convex scribe, contour profile scribing and line block. • For use by all trades, carpenters, joiners and builders etc.
- Built in spirit level & pencil sharpener.
- Steel blade with $13/64"$ and $1/4"$ graduations for profiling.

Ref.
U*MS/PRO



METRIC & IMPERIAL DIGITAL DEPTH GAUGE

Horizontal and vertical measuring.

- For hand routers, router tables and saw benches.
- LCD readout for mm, inches and fractions with auto shut off 5 mins.
- Removable pin to allow hole depths to be measured. Pin can be parked on arm. Hole depth 2".
- Self standing with magnetic feet and flat back.
- Injection plastic moulding with plastic rule.
- Read-out has relative co-ordinate and absolute function.
- $2-3/8"$ wide aperture.

Ref.
U*GAUGE/D60

REPLACEMENT PART

Battery CR2032 3v
U*BAT/CR2032/3V



AIRSHIELD PRO

AIR CIRCULATING FACE SHIELD

An all-in-one, fully protected air circulating face shield that delivers a steady flow of fresh, filtered air for comfortable prolonged use. Provides respiratory protection against harmful hardwood, brick, concrete and stone fine dust particles for prolonged periods. The self-contained, head-mounted system (without trailing leads or hoses) is ideal for regular workshop and site use.



Positive Pressure Respiratory Protection

Removes the need for on-site face fit testing and prevents fogging and misting



Panoramic Flip-Up Visor

Provides excellent all-round vision and protects eyes and face against flying debris (medium energy impact) and splashes - can be protected using optional Visor Overlays (AIR/P/3C)

2x
TH2P

Twin Filters

Deliver 98% filtration performance



Rear-Mounted Ultra-Quiet Fan & Motor

Supplies 210l/min of filtered air whilst minimising noise and optimising balance

Removable 8-Hour Battery

Provides all-day power for maximum uptime and can be recharged on-board or in a cradle (AIR/P/5)

Integral Ear Defender Mounting Points

Compatible with AIR/P/6A ear defenders to protect against machine noise

Quick-Release Headband

Adjusts between 20-15/32" and 24-13/32"

Visual & Audible Air-Flow Warning Indicators

To ensure the battery and filters are providing maximum protection

Combination Face Seal & Hood

Ensures contaminated air cannot enter the respirator. Ideal for those with facial hair and prescription glasses



U*AIR/PRO

COMPLETE FACE AND HEARING PROTECTION PACK:**U*AIR/PRO/D2****AIRSHIELD PRO****AIR CIRCULATING
FACE SHIELD****x1****U*AIR/PRO****EAR DEFENDERS****x1****U*AIR/P/6A****FACE SHIELD BUNDLE:****U*AIR/PRO/D5****AIRSHIELD PRO****AIR CIRCULATING
FACE SHIELD****x1****U*AIR/PRO****10 PACK OF
VISOR OVERLAY****1x10****U*AIR/P/3C****PACK OF TH2P
REPLACEMENT
TWIN AIR FILTERS****1x2****U*AIR/P/1****FACE SHIELD BUNDLE:****U*AIR/PRO/D6****AIRSHIELD PRO****AIR CIRCULATING
FACE SHIELD****x1****U*AIR/PRO****8-HOUR
REPLACEMENT
RECHARGEABLE
BATTERY****x1****U*AIR/P/4****CHARGING
CRADLE****x1****U*AIR/P/7**

Eye protection to ANSI Z87+ (High energy impact). Respiratory protection (for reference only) NPF50 to EN 12941 TH2P. Not NIOSH approved.

GAME CHANGING SANDING TECHNOLOGY

Trend high performance abrasives give a high quality finish, are long lasting and increase productivity. Our range includes machine abrasives as well as pad savers and finishing pads in a wide range of grits.

SUITABLE FOR



Wood



Painted Wall



Plaster



Metal

FILM





Available in 40, 60, 80, 120, 150, 180 & 240 Grit

PROFESSIONAL

MESH

Available in 80, 120, 150, 180, 240, 320 & 400 Grit

ABRASIVES USAGE

	COARSE		MEDIUM				FINE		EXTRA FINE	
MATERIAL	40G	60G	80G	120G	150G	180G	240G	320G	400G	
	✓	✓	✓	✓	✓	✓	✓	✓	✓	
	-	-	✓	✓	✓	✓	✓	✓	✓	
	-	-	✓	✓	✓	✓	✓	✓	✓	
	-	-	✓	✓	✓	✓	✓	✓	✓	

PAD SAVERS

Our range of universal fitment, hook and loop pad savers will prolong the life of your sander when using mesh abrasives.



U*AB/PAD/125
125mm Random Orbital Pad Saver - 2pk

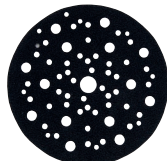

U*AB/PAD/150
150mm Random Orbital Pad Saver - 2pk

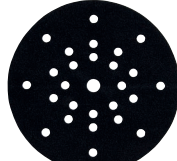

U*AB/PAD/225
225mm Drywall Pad Saver - 2pk



U*AB/PAD/OSC
93mm Delta Pad Saver - 2pk



U*AB/PAD/DET
100 x 150mm Detail Pad Saver - 2pk

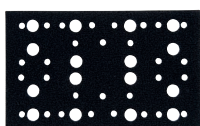

U*AB/PAD/133
80 x 133mm Pad Saver - 2pk

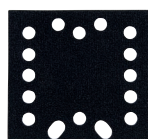

U*AB/PAD/QTR
115 x 107mm Quarter Sheet Pad Saver - 2pk

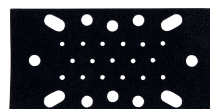

U*AB/PAD/THD
93 x 185mm Third Sheet Pad Saver - 2pk

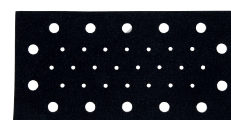

U*AB/PAD/HLF
115 x 230mm Half Sheet Pad Saver - 2pk

OUR FULL RANGE OF ABRASIVES



FILM

Available in 40, 60, 80, 120, 150, 180 & 240 Grit

PROFESSIONAL

MESH

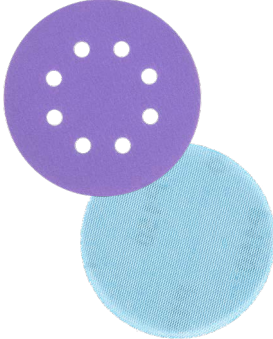
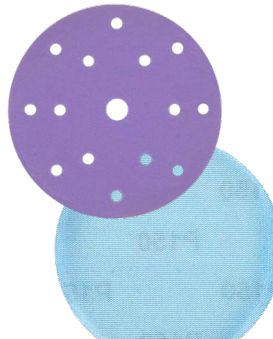
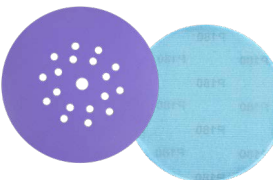
Available in 80, 120, 150, 180, 240, 320 & 400 Grit

Sander	Product Ref.	Type	Grit	Material	Pack Size
125mm Random Orbital Sanding Discs 	U*AB/125/40Z	125mm Random Orbital Sanding Disc	40	Film	10
	U*AB/125/60Z	125mm Random Orbital Sanding Disc	60	Film	10
	U*AB/125/80Z	125mm Random Orbital Sanding Disc	80	Film	10
	U*AB/125/120A	125mm Random Orbital Sanding Disc	120	Film	10
	U*AB/125/150A	125mm Random Orbital Sanding Disc	150	Film	10
	U*AB/125/180A	125mm Random Orbital Sanding Disc	180	Film	10
	U*AB/125/240A	125mm Random Orbital Sanding Disc	240	Film	10
	U*AB/125/80P	Professional 125mm Random Orbital Sanding Disc	80	Mesh	5
	U*AB/125/120P	Professional 125mm Random Orbital Sanding Disc	120	Mesh	5
	U*AB/125/150P	Professional 125mm Random Orbital Sanding Disc	150	Mesh	5
	U*AB/125/180P	Professional 125mm Random Orbital Sanding Disc	180	Mesh	5
	U*AB/125/240P	Professional 125mm Random Orbital Sanding Disc	240	Mesh	5
	U*AB/125/320P	Professional 125mm Random Orbital Sanding Disc	320	Mesh	5
	U*AB/125/400P	Professional 125mm Random Orbital Sanding Disc	400	Mesh	5
150mm Random Orbital Sanding Discs 	U*AB/150/40Z	150mm Random Orbital Sanding Disc	40	Film	10
	U*AB/150/60Z	150mm Random Orbital Sanding Disc	60	Film	10
	U*AB/150/80Z	150mm Random Orbital Sanding Disc	80	Film	10
	U*AB/150/120A	150mm Random Orbital Sanding Disc	120	Film	10
	U*AB/150/150A	150mm Random Orbital Sanding Disc	150	Film	10
	U*AB/150/180A	150mm Random Orbital Sanding Disc	180	Film	10
	U*AB/150/240A	150mm Random Orbital Sanding Disc	240	Film	10
	U*AB/150/80P	Professional 150mm Random Orbital Sanding Disc	80	Mesh	5
	U*AB/150/120P	Professional 150mm Random Orbital Sanding Disc	120	Mesh	5
	U*AB/150/150P	Professional 150mm Random Orbital Sanding Disc	150	Mesh	5
	U*AB/150/180P	Professional 150mm Random Orbital Sanding Disc	180	Mesh	5
	U*AB/150/240P	Professional 150mm Random Orbital Sanding Disc	240	Mesh	5
	U*AB/150/320P	Professional 150mm Random Orbital Sanding Disc	320	Mesh	5
	U*AB/150/400P	Professional 150mm Random Orbital Sanding Disc	400	Mesh	5
225mm Random Orbital Sanding Discs 	U*AB/225/80Z	225mm Drywall Sanding Disc	80	Film	10
	U*AB/225/120A	225mm Drywall Sanding Disc	120	Film	10
	U*AB/225/180A	225mm Drywall Sanding Disc	180	Film	10
	U*AB/225/240A	225mm Drywall Sanding Disc	240	Film	10
	U*AB/225/80P	Professional 225mm Drywall Sanding Disc	80	Mesh	5
	U*AB/225/120P	Professional 225mm Drywall Sanding Disc	120	Mesh	5
	U*AB/225/180P	Professional 225mm Drywall Sanding Disc	180	Mesh	5
	U*AB/225/240P	Professional 225mm Drywall Sanding Disc	240	Mesh	5
93mm Delta Sanding Pads 	U*AB/OSC/40Z	93mm Delta Sanding Pad	40	Film	10
	U*AB/OSC/60Z	93mm Delta Sanding Pad	60	Film	10
	U*AB/OSC/80Z	93mm Delta Sanding Pad	80	Film	10
	U*AB/OSC/120A	93mm Delta Sanding Pad	120	Film	10
	U*AB/OSC/150A	93mm Delta Sanding Pad	150	Film	10
	U*AB/OSC/180A	93mm Delta Sanding Pad	180	Film	10
	U*AB/OSC/240A	93mm Delta Sanding Pad	240	Film	10
	U*AB/OSC/80P	Professional 93mm Delta Sanding Pad	80	Mesh	5
	U*AB/OSC/120P	Professional 93mm Delta Sanding Pad	120	Mesh	5
	U*AB/OSC/150P	Professional 93mm Delta Sanding Pad	150	Mesh	5
	U*AB/OSC/180P	Professional 93mm Delta Sanding Pad	180	Mesh	5
	U*AB/OSC/240P	Professional 93mm Delta Sanding Pad	240	Mesh	5
	U*AB/OSC/320P	Professional 93mm Delta Sanding Pad	320	Mesh	5
	U*AB/OSC/400P	Professional 93mm Delta Sanding Pad	400	Mesh	5

OUR FULL RANGE OF ABRASIVES CONT...

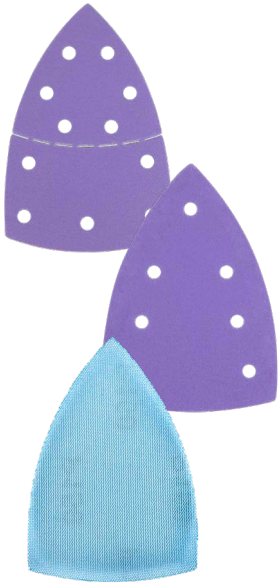
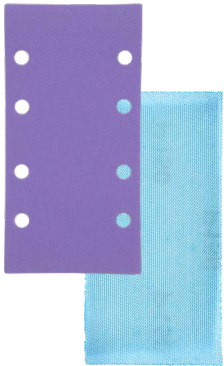
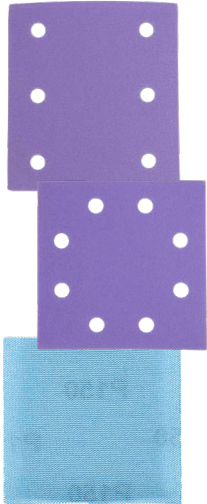
Sander	Product Ref.	Type	Grit	Material	Pack Size
Detail Sanding Sanding Pads 	U*AB/DET/40Z	100 x 150mm Detail Sanding Pad - 11 Hole	40	Film	10
	U*AB/DET/60Z	100 x 150mm Detail Sanding Pad - 11 Hole	60	Film	10
	U*AB/DET/80Z	100 x 150mm Detail Sanding Pad - 11 Hole	80	Film	10
	U*AB/DET/120A	100 x 150mm Detail Sanding Pad - 11 Hole	120	Film	10
	U*AB/DET/150A	100 x 150mm Detail Sanding Pad - 11 Hole	150	Film	10
	U*AB/DET/180A	100 x 150mm Detail Sanding Pad - 11 Hole	180	Film	10
	U*AB/DET/240A	100 x 150mm Detail Sanding Pad - 11 Hole	240	Film	10
	U*AB/DET1/40Z	100 x 150mm Detail Sanding Pad - 7 Hole	40	Film	10
	U*AB/DET1/60Z	100 x 150mm Detail Sanding Pad - 7 Hole	60	Film	10
	U*AB/DET1/80Z	100 x 150mm Detail Sanding Pad - 7 Hole	80	Film	10
	U*AB/DET1/120A	100 x 150mm Detail Sanding Pad - 7 Hole	120	Film	10
	U*AB/DET1/150A	100 x 150mm Detail Sanding Pad - 7 Hole	150	Film	10
	U*AB/DET1/180A	100 x 150mm Detail Sanding Pad - 7 Hole	180	Film	10
	U*AB/DET1/240A	100 x 150mm Detail Sanding Pad - 7 Hole	240	Film	10
	U*AB/DET/80P	Professional 100 x 150mm Detail Sanding Pad	80	Mesh	5
	U*AB/DET/120P	Professional 100 x 150mm Detail Sanding Pad	120	Mesh	5
	U*AB/DET/150P	Professional 100 x 150mm Detail Sanding Pad	150	Mesh	5
	U*AB/DET/180P	Professional 100 x 150mm Detail Sanding Pad	180	Mesh	5
	U*AB/DET/240P	Professional 100 x 150mm Detail Sanding Pad	240	Mesh	5
	U*AB/DET/320P	Professional 100 x 150mm Detail Sanding Pad	320	Mesh	5
	U*AB/DET/400P	Professional 100 x 150mm Detail Sanding Pad	400	Mesh	5
80 x 133mm Sanding Pads 	U*AB/133/40Z	80 x 133mm Sanding Pad	40	Film	10
	U*AB/133/60Z	80 x 133mm Sanding Pad	60	Film	10
	U*AB/133/80Z	80 x 133mm Sanding Pad	80	Film	10
	U*AB/133/120A	80 x 133mm Sanding Pad	120	Film	10
	U*AB/133/150A	80 x 133mm Sanding Pad	150	Film	10
	U*AB/133/180A	80 x 133mm Sanding Pad	180	Film	10
	U*AB/133/240A	80 x 133mm Sanding Pad	240	Film	10
	U*AB/133/80P	Professional 80 x 133mm Sanding Pad	80	Mesh	5
	U*AB/133/120P	Professional 80 x 133mm Sanding Pad	120	Mesh	5
	U*AB/133/150P	Professional 80 x 133mm Sanding Pad	150	Mesh	5
	U*AB/133/180P	Professional 80 x 133mm Sanding Pad	180	Mesh	5
	U*AB/133/240P	Professional 80 x 133mm Sanding Pad	240	Mesh	5
	U*AB/133/320P	Professional 80 x 133mm Sanding Pad	320	Mesh	5
	U*AB/133/400P	Professional 80 x 133mm Sanding Pad	400	Mesh	5
115 x 115mm & 115 x 107mm Quarter Sanding Pads 	U*AB/QTR/40Z	115 x 115mm Quarter Sheet Sanding Pad - 8 Hole	40	Film	10
	U*AB/QTR/60Z	115 x 115mm Quarter Sheet Sanding Pad - 8 Hole	60	Film	10
	U*AB/QTR/80Z	115 x 115mm Quarter Sheet Sanding Pad - 8 Hole	80	Film	10
	U*AB/QTR/120A	115 x 115mm Quarter Sheet Sanding Pad - 8 Hole	120	Film	10
	U*AB/QTR/150A	115 x 115mm Quarter Sheet Sanding Pad - 8 Hole	150	Film	10
	U*AB/QTR/180A	115 x 115mm Quarter Sheet Sanding Pad - 8 Hole	180	Film	10
	U*AB/QTR/240A	115 x 115mm Quarter Sheet Sanding Pad - 8 Hole	240	Film	10
	U*AB/QTR1/40Z	115 x 107mm Quarter Sheet Sanding Pad - 6 Hole	40	Film	10
	U*AB/QTR1/60Z	115 x 107mm Quarter Sheet Sanding Pad - 6 Hole	60	Film	10
	U*AB/QTR1/80Z	115 x 107mm Quarter Sheet Sanding Pad - 6 Hole	80	Film	10
	U*AB/QTR1/120A	115 x 107mm Quarter Sheet Sanding Pad - 6 Hole	120	Film	10
	U*AB/QTR1/150A	115 x 107mm Quarter Sheet Sanding Pad - 6 Hole	150	Film	10
	U*AB/QTR1/180A	115 x 107mm Quarter Sheet Sanding Pad - 6 Hole	180	Film	10
	U*AB/QTR1/240A	115 x 107mm Quarter Sheet Sanding Pad - 6 Hole	240	Film	10
	U*AB/QTR/80P	Professional 115 x 107mm Quarter Sheet Sanding Pad	80	Mesh	5
	U*AB/QTR/120P	Professional 115 x 107mm Quarter Sheet Sanding Pad	120	Mesh	5
	U*AB/QTR/150P	Professional 115 x 107mm Quarter Sheet Sanding Pad	150	Mesh	5
	U*AB/QTR/180P	Professional 115 x 107mm Quarter Sheet Sanding Pad	180	Mesh	5
	U*AB/QTR/240P	Professional 115 x 107mm Quarter Sheet Sanding Pad	240	Mesh	5
	U*AB/QTR/320P	Professional 115 x 107mm Quarter Sheet Sanding Pad	320	Mesh	5
	U*AB/QTR/400P	Professional 115 x 107mm Quarter Sheet Sanding Pad	400	Mesh	5

FILM



Available in 40, 60, 80, 120,
150, 180 & 240 Grit

PROFESSIONAL

MESH

Available in 80, 120, 150, 180,
240, 320 & 400 Grit

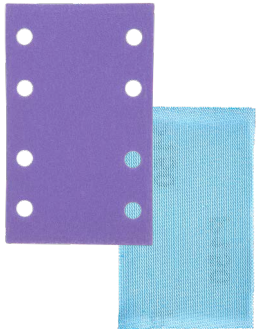

Sander	Product Ref.	Type	Grit	Material	Pack Size
93 x 115mm Third Sheet Sanding Pads 	U*AB/THD/40Z	93 x 185mm Third Sheet Sanding Pad	40	Film	10
	U*AB/THD/60Z	93 x 185mm Third Sheet Sanding Pad	60	Film	10
	U*AB/THD/80Z	93 x 185mm Third Sheet Sanding Pad	80	Film	10
	U*AB/THD/120A	93 x 185mm Third Sheet Sanding Pad	120	Film	10
	U*AB/THD/150A	93 x 185mm Third Sheet Sanding Pad	150	Film	10
	U*AB/THD/180A	93 x 185mm Third Sheet Sanding Pad	180	Film	10
	U*AB/THD/240A	93 x 185mm Third Sheet Sanding Pad	240	Film	10
	U*AB/THD/80P	Professional 93 x 185mm Third Sheet Sanding Pad	80	Mesh	5
	U*AB/THD/120P	Professional 93 x 185mm Third Sheet Sanding Pad	120	Mesh	5
	U*AB/THD/150P	Professional 93 x 185mm Third Sheet Sanding Pad	150	Mesh	5
	U*AB/THD/180P	Professional 93 x 185mm Third Sheet Sanding Pad	180	Mesh	5
	U*AB/THD/240P	Professional 93 x 185mm Third Sheet Sanding Pad	240	Mesh	5
	U*AB/THD/320P	Professional 93 x 185mm Third Sheet Sanding Pad	320	Mesh	5
	U*AB/THD/400P	Professional 93 x 185mm Third Sheet Sanding Pad	400	Mesh	5
115 x 230mm Half Sheet Sanding Pads 	U*AB/HLF/40Z	115 x 230mm Half Sheet Sanding Pad	40	Film	10
	U*AB/HLF/60Z	115 x 230mm Half Sheet Sanding Pad	60	Film	10
	U*AB/HLF/80Z	115 x 230mm Half Sheet Sanding Pad	80	Film	10
	U*AB/HLF/120A	115 x 230mm Half Sheet Sanding Pad	120	Film	10
	U*AB/HLF/150A	115 x 230mm Half Sheet Sanding Pad	150	Film	10
	U*AB/HLF/180A	115 x 230mm Half Sheet Sanding Pad	180	Film	10
	U*AB/HLF/240A	115 x 230mm Half Sheet Sanding Pad	240	Film	10
	U*AB/HLF/80P	Professional 115 x 230mm Half Sheet Sanding Pad	80	Mesh	5
	U*AB/HLF/120P	Professional 115 x 230mm Half Sheet Sanding Pad	120	Mesh	5
	U*AB/HLF/150P	Professional 115 x 230mm Half Sheet Sanding Pad	150	Mesh	5
	U*AB/HLF/180P	Professional 115 x 230mm Half Sheet Sanding Pad	180	Mesh	5
	U*AB/HLF/240P	Professional 115 x 230mm Half Sheet Sanding Pad	240	Mesh	5
	U*AB/HLF/320P	Professional 115 x 230mm Half Sheet Sanding Pad	320	Mesh	5
	U*AB/HLF/400P	Professional 115 x 230mm Half Sheet Sanding Pad	400	Mesh	5



BULK PACKS

Product Ref.	Type	Grit	Material	Pack Size
U*AB/125/M25	125mm Random Orbital Sanding Disc	60/120/180/240	Film	25
U*AB/150/M25	150mm Random Orbital Sanding Disc	60/120/180/240	Film	25
U*AB/225/80Z/B	225mm Drywall Sanding Disc	80	Film	25
U*AB/225/120A/B	225mm Drywall Sanding Disc	120	Film	25
U*AB/225/180A/B	225mm Drywall Sanding Disc	180	Film	25
U*AB/225/240A/B	225mm Drywall Sanding Disc	240	Film	25



ASSORTED PACKS

Product Ref.	Type	Grit	Material	Pack Size
U*AB/125/M6	125mm Random Orbital Sanding Disc	60/120/240	Film	6
U*AB/150/M6	150mm Random Orbital Sanding Disc	60/120/240	Film	6
U*AB/OSC/M6	93mm Delta Sanding Pad	60/120/240	Film	6
U*AB/DET/M6	100 x 150mm Detail Sanding Pad - 11 Hole	60/120/240	Film	6
U*AB/DET1/M6	100 x 150mm Detail Sanding Pad - 7 Hole	60/120/240	Film	6
U*AB/133/M6	80 x 133mm Sanding Pad	60/120/240	Film	6
U*AB/QTR/M6	115 x 115mm Quarter Sheet Sanding Pad - 8 Hole	60/120/240	Film	6
U*AB/QTR1/M6	115 x 107mm Quarter Sheet Sanding Pad - 6 Hole	60/120/240	Film	6
U*AB/THD/M6	93 x 185mm Third Sheet Sanding Pad	60/120/240	Film	6
U*AB/HLF/M6	115 x 230mm Half Sheet Sanding Pad	60/120/240	Film	6
U*AB/125/M7/P	Professional 125mm Random Orbital Sanding Disc	80/120/180/Pad Saver	Mesh	6+1
U*AB/150/M7/P	Professional 150mm Random Orbital Sanding Disc	80/120/180/Pad Saver	Mesh	6+1
U*AB/OSC/M7/P	Professional 93mm Delta Sanding Pad	80/120/180/Pad Saver	Mesh	6+1
U*AB/DET/M7/P	Professional 100 x 150mm Detail Sanding Pad	80/120/180/Pad Saver	Mesh	6+1
U*AB/133/M7/P	Professional 80 x 133mm Sanding Pad	80/120/180/Pad Saver	Mesh	6+1
U*AB/QTR/M7/P	Professional 115 x 107mm Quarter Sheet Sanding Pad	80/120/180/Pad Saver	Mesh	6+1
U*AB/THD/M7/P	Professional 93 x 185mm Third Sheet Sanding Pad	80/120/180/Pad Saver	Mesh	6+1
U*AB/HLF/M7/P	Professional 115 x 230mm Half Sheet Sanding Pad	80/120/180/Pad Saver	Mesh	6+1



FINISHING PADS USAGE

Our range of flexible, reusable abrasive finishing pads are perfect for paint removal, material preparation and polishing applications.

SUITABLE FOR



Wood



Painted Wall



Plaster



Metal



Composites



Polishing

COARSE

Available in 40 & 60 Grit

MEDIUM

Available in 80, 120 & 150 Grit

FINE

Available in 180 & 240 Grit

MATERIAL	COARSE 40 & 60G	MEDIUM 80G, 120G, 150G	FINE 180G, 240G
	✓	✓	✓
	✓	-	-
	✓	✓	✓
	✓	✓	✓
	✓	✓	✓
	-	✓	✓



U*AB/PAD/CRS
Coarse 150 x 230mm Finishing Pads
- 3pk



U*AB/PAD/MED
Medium 150 x 230mm Finishing Pads
- 3pk



U*AB/PAD/FINE
Fine 150 x 230mm Finishing Pads
- 3pk



U*AB/PAD/M3
Mixed 150 x 230mm Finishing Pads
- 3pk



CLASSIC PROFESSIONAL BENCH STONES



Unique combination of surfaces for optimum performance.



**Ideal for up to 3"
Plane Irons and Chisels**



**Unique Clearance Channel on Coarse
Side to Produce Faster, Cleaner Cut**



**Solid Diamond
Surface on Fine Side**



**Precision Flatness,
with Pre-Ground Substrate**



**Diamond Shaped Surface Prevents Snagging
When Sharpening Small or Pointed Tooling**



**Ex-Fine 1000 Grit (15 Micron)
and Coarse 300 Grit (50 Micron)**



**Continuous Diamond Fine Surface Ideal for
Fine Honing of Knives, Plane Blades and Chisels**



COARSE SIDE
300 Grit 50 Micron

EXTRA FINE SIDE
1000 Grit 15 Micron

Size: 8" x 3" x 5/16"



CONTACT

Telephone Toll Free (877) 918-7363
Retailer & Wholesaler Sales (336) 292-5051
Technical Support (336) 292-5051
General Fax (336) 292-5061
Email sales@trend-usa.com
Web www.trend-usa.com

Trend Tool Technology Ltd.
7351 West Friendly Avenue
Suite A
Greensboro, NC 27410

Available from:



www.trend-usa.com

As well as our feature-packed website which will tell you all you need to know about our products and how to use them, we are also active on all major social media platforms.



@trendtooltechnology



Trend Tool Technology



@trendtooltechnology



@trendtooltech



Trendtools



@trend_tool_technology



Trend Tool Technology

**WHY NOT SUBSCRIBE & ENSURE THAT YOU GET TO
SEE ALL THE LATEST DEVELOPMENTS, HINTS, TIPS &
OFFERS?**