

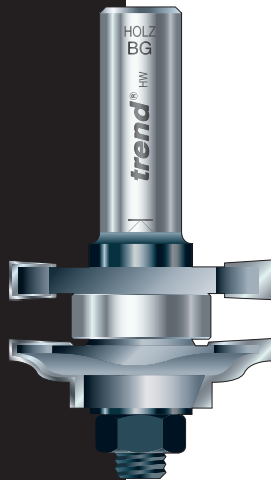

## Profile Scriber Multi-set PSC/MS1



**trend**  
routing technology

INST/PSC/MS1 v7.0

Please  
read carefully  
before use

### PROFILE SCRIBER MULTI-SET REF. PSC/MS1

Thank you for purchasing this Trend router cutter set, which should give lasting performance if used in accordance with these instructions.

The following instructions apply to the Trend Profile Scriber Multi-set whether fitted with an 8mm arbor or with a 1/2" arbor.

You will find in this box one Profile Scriber assembly, two extra profile blocks, one extra groover, a shim set and two spacers.

The following symbols are used throughout these instructions.



Denotes risk of personal injury, loss of life or damage to the tool in case of non-observance of the instructions.



Refer to the instruction manual of your power tool.

This cutter must not be put into service until it has been established that the power tool to be connected to this unit is in compliance with 98/37/EC (identified by the CE marking on the power tool).

#### INTENDED USE

All the Profile Scribes and the Tongue & Groove set-ups should be used in a fixed position, either mounted in an overhead or table routing machine, or in a portable router mounted

in a fixed mode.

These set-ups, if supplied with an 8mm arbor can be used in smaller portable routers fitted with an 8mm collet and used in a fixed mode. Please take many light passes with 8mm shank tooling.

#### SAFETY

Please read and understand the safety points at the end of this instruction as well as the power tool instructions before use.

PLEASE KEEP THESE INSTRUCTIONS IN A SAFE PLACE.

The attention of UK users is drawn to The Provision and Use of Work Equipment Regulations 1998, and any subsequent amendments.

Users should also read the HSE/HSC Safe Use of Woodworking Machinery Approved Code of Practice and Guidance Document and any amendments.

Users must be competent in using woodworking equipment before using our products.

Attention should be made to the HSE's Safe Use of Vertical Spindle Moulding machines Information Sheet No. 18 and any revisions.

#### ITEMS REQUIRED

- Router with suitable collet fitted
- Router table or overhead router stand
- Hand tools
- Jig making equipment & materials
- Workholder

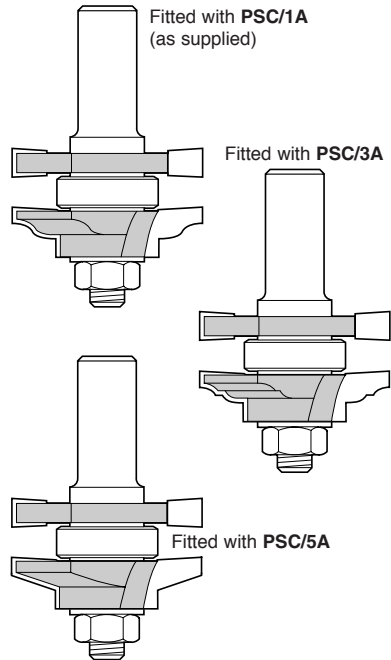

#### SETTING UP FOR PROFILE SCRIBING

The main assembly is supplied with block PSC/1A set up in scribing mode.

This set-up is used for cutting the scribe across the ends of the rails. A workholder should

be used as the rails will be too narrow to run against a fence. This also has the advantage of making the operation safer and more accurate.

The height of the cutter should be adjusted according to the thickness of the timber.

When converted to profile mode the assembly is used for cutting the profile along the wood. The wood should be inverted first. The height of the cutter should be adjusted according to the scribe.

#### SETTING UP FOR TONGUE & GROOVE

The parts are rearranged on the arbor to cut the tongue and the groove.

Follow the sequence of the diagrams on the reverse of this leaflet. Once set up in tongue mode, the arbor can be left in the collet of the router and parts simply rearranged on the arbor, as the top spacer and shims allow for the offset of the top groover. The height of the cutter will need to be adjusted and then checked before machining the groove.

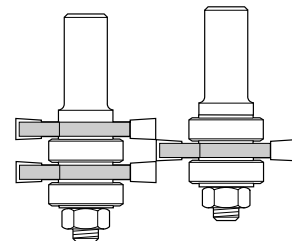

**ENVIRONMENTAL PROTECTION**  
Recycle raw materials instead of disposing as waste.

Packaging should be sorted for environmental-friendly recycling. The product and its accessories at the end of its life should be sorted for environmental-friendly recycling.

#### GUARANTEE

All Trend products are guaranteed against any defects in either workmanship or material, except products that have been damaged due to improper use or maintenance.

© Trend Machinery & Cutting Tools Ltd. 2007 E&OE  
© All trademarks acknowledged

**Trend Machinery & Cutting Tools Ltd.**

Odhams Trading Estate St. Albans Road  
Watford WD24 7TR England

Enquiries: \_\_\_\_\_ 0800 487363

Technical Support: 0044 (0) 1923 224681

Fax: \_\_\_\_\_ 0044 (0) 1923 236879

Email: \_\_\_\_\_ enquiry@trendm.co.uk

Web: \_\_\_\_\_ www.trend-uk.com



RS 28982  
Stockholding  
& Supply



RECYCLABLE

## PARTS SUPPLIED IN SET

see diagrams

- |     |                            |           |
|-----|----------------------------|-----------|
| 1.  | Arbor                      | <b>x1</b> |
| 2.  | Nut 13mm A/F               | <b>x1</b> |
| 3A. | Profile Block - PSC/1A     | <b>x1</b> |
| 3B. | Profile Block - PSC/3A     | <b>x1</b> |
| 3C. | Profile Block - PSC/5A     | <b>x1</b> |
| 3D. | Groover 6.3mm              | <b>x1</b> |
| 4.  | Groover 6.3mm              | <b>x1</b> |
| 5.  | Ball Bearing 22mm Diameter | <b>x2</b> |
| 6.  | Washer 1.0mm               | <b>x2</b> |
| 7.  | Shim 0.1mm                 | <b>x3</b> |
| 8.  | Shim 0.05mm                | <b>x3</b> |
| 9.  | Spacer 6mm                 | <b>x1</b> |

Parts 3 & 4 should be assembled square to each other to reduce the cutting impact.

Changes in tightness can be achieved by adding or removing shims 7 & 8. This is most important after resharpening.

The ball bearing will automatically give the correct depth of cut.

When reassembling follow the sequence of the diagrams.



The tool is factory set, and the shims/spacers supplied may differ from the list above. Some shims/spacers can be found assembled on the tool.

## SCRIBE SET-UP

as supplied

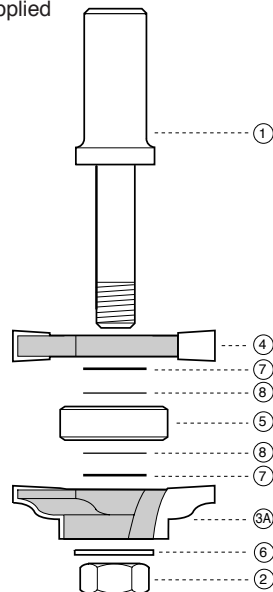

Before using cutter, please ensure it is correctly assembled and locking nut is fully tightened to correct torque setting



Recommended speed is 24,000rpm

## PROFILE SET-UP

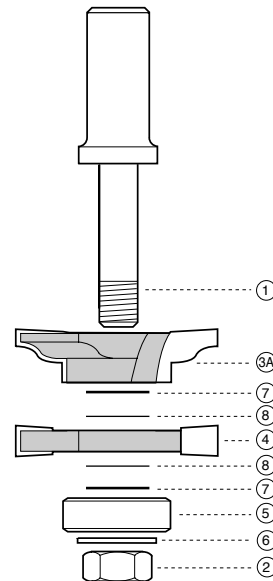

These blocks can be interchanged for 3A.

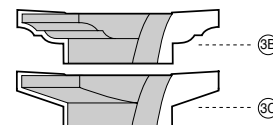

## TONGUE SET-UP

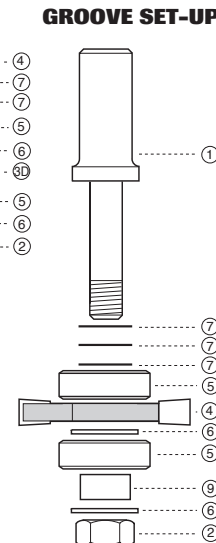
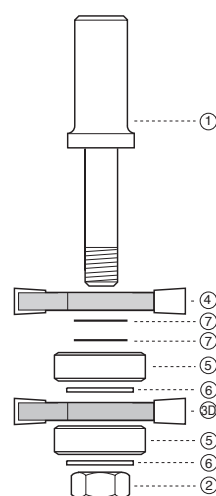

A booklet Ref. **BOOK/PD** 'How to Make a Frame & Panel Cabinet Door', illustrates in detail the use of Profile Scriber Sets and is available on request.

## GROOVE SET-UP

## SPARE PARTS

Description	Order Ref.
Profile Block for PSC/1	<b>PSC/1A</b>
Profile Block for PSC/3	<b>PSC/3A</b>
Profile Block for PSC/5	<b>PSC/5A</b>
Groover 6.3mm	<b>SP-34/70TC</b>
Bearing 22mm Ø	<b>BB22</b>
Replacement Arbor 1/2"	<b>33/30x1/2</b>
Replacement Arbor 8mm	<b>33/30x8mm</b>
Alternative Arbor 12mm	<b>33/30x12mm</b>
Replacement Arbor Nut	<b>ANUT/33/30</b>
Spacer Set	<b>SPACER/8</b>

— Shim 0.05mm Shim set for use after resharpening or if tight or loose joints are required.

— Shim 0.1mm

Ball bearing 22mm

Spacer 6.0mm Spacer and ball bearing for use with set in tongue and groove mode.

## MAINTENANCE

Continual satisfactory operation depends upon proper tool care and regular cleaning.

### Cleaning

- Remove resin build-up regularly.
- Apply a rust protector to shanks. Do not use rust protector on ball bearing guides

### Lubrication

- Use a PTFE dry lubricant spray on tool.
- Apply a rust protector to shanks. Do not use rust protector on ball bearing guides

### Storage

- Return cutter to its packaging after use.

## Safety Points

- Disconnect power tool and attachment from power supply when not in use, before servicing, when making adjustments and when changing accessories such as cutters. Ensure switch is in 'off' position and cutter has stopped rotating.
- Read and understand instructions supplied with power tool, attachment and cutter.
- Current Personal Protective Equipment (PPE) for eye, ear and respiratory protection must be worn. Keep hands, hair and clothes clear of the cutter.
- Before each use check cutter is sharp and free from damage. Do not use if cutter is dull, broken or cracked or if any damage is noticeable or suspected.
- The maximum speed (nmax) marked on tool or in instructions or on packaging shall not be exceeded. Where stated, the speed range should be adhered to.
- Insert the shank into the router collet at least all the way to the marked line indicated on the shank. This ensures at least 3/4 of shank length is held in collet. Ensure clamping surfaces are clean.
- Check all fixing and fastening nuts, bolts and screws on power tool, attachment and cutting tools are correctly assembled, tight and to correct torque setting before use.
- Ensure all visors, guards and dust extraction is fitted.
- The direction of routing must always be opposite to the cutter's direction of rotation.
- Do not switch power tool on with the cutter touching the workpiece.
- Trial cuts should be made in waste material before starting any project.
- Repair of tools is only allowed according to tool manufacturers instructions.

Please see [www.trend-uk.com/safety](http://www.trend-uk.com/safety) for more safety advice.



Our policy of continuous improvements mean that specifications may change without notice. Trend Machinery & Cutting Tools Ltd. cannot be held liable for any material rendered unusable, or for any form of consequential loss.