



Mini Routabout M/RBT

Please
read carefully
before use

MINI ROUTABOUT REF. M/RBT

Thank you for purchasing this Trend product, which should give lasting performance if used in accordance with these instructions.

The following symbols are used throughout these instructions.



Denotes risk of personal injury, loss of life or damage to the tool in case of non-observance of the instructions.



Refer to the instruction manual of your power tool.

This unit must not be put into service until it has been established that the power tool to be connected to this unit is in compliance with 2006/42/EC (identified by the CE marking on the power tool).

INTENDED USE

This accessory is intended to be used with a plunge router, with suitable guide bush and cutter fitted to rout access holes in suitable thickness chipboard, plywood or sterling board floors.

Size:

Hole diameter 108mm (4 1/4").

Floor thickness 18mm (0.702") - Ref. M/RBT/1 or M/RBT/3.

Floor thickness 22mm (7/8") - Ref. M/RBT/2 or M/RBT/4.



Maximum load capacity on each cover is 380 kg



The Mini Routabout routing process is different to the standard Routabout. Please read these instructions carefully.

SAFETY

Please read and understand the safety points at end of this instruction as well as the power tool instructions before use.

PLEASE KEEP THESE INSTRUCTIONS IN A SAFE PLACE.

The attention of UK users is drawn to The Provision and Use of Work Equipment Regulations 1998, and any subsequent amendments.

Users should also read the HSE/HSC Safe Use of Woodworking Machinery Approved Code of Practice and Guidance Document and any amendments.

Users must be competent in using woodworking equipment before using our products.

Please keep children away from tools and work area. All power tools will have a residual risk, so must therefore be operated with care.



Consider work environment before using tools.



Ensure working position is comfortable.

ITEMS REQUIRED

- Plunge router with suitable size collet fitted.
- No.2 Pozi® screwdriver.
- Small pad saw.

Ref. Unibase

For certain makes of router, a sub-base will be required to allow the guide bush to be fitted.



Please refer to Building Regulations Approved Document B, and any amendments before use of the accessory.

ITEMS ENCLOSED & DESCRIPTION OF PARTS

- A. Template **x1**
- B. Tungsten Carbide Tipped Cutter **x1**
- C. Mini Routabout Cover **x3**
- D. 30mm Plastic Guide Bush **x1**
- E. Fixing Screw **x1**
- F. Instructions **x1**

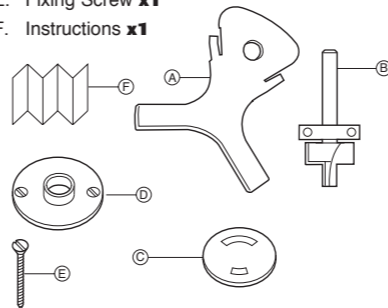

ASSEMBLY

Guide Bushes

The bush supplied with the jig is standard Trend pattern. It will fit most Trend, Elu and Dewalt routers directly.

For other makes and model of router a sub-base may be required to allow the guide bush to be fitted. The Universal sub-base Ref. UNIBASE has been designed for use with a variety of routers; it also ensures concentricity between cutter and guide bush ensuring accuracy.

Setting up the Router

1. Isolate router from power supply.
2. Fit guide bush to router.
3. Fit router cutter into router.

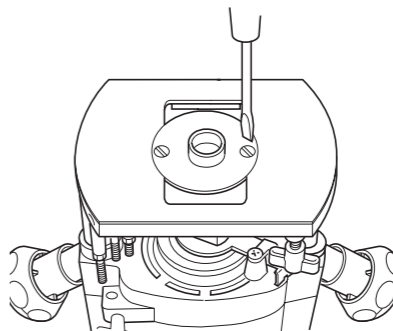

PTO

ENVIRONMENTAL PROTECTION

Recycle raw materials instead of disposing as waste.

Packaging should be sorted for environmental-friendly recycling.

The product and its accessories at the end of its life should be sorted for environmental-friendly recycling.

GUARANTEE

All Trend products are guaranteed against any defects in either workmanship or material, except products that have been damaged due to improper use or maintenance.

© Trend Machinery & Cutting Tools Ltd. 2013 E&OE

© All trademarks acknowledged

Trend Machinery & Cutting Tools Ltd

Odhams Trading Estate St Albans Road

Watford WD24 7TR England

Tel: 0044(0)1923 249911

technical@trendm.co.uk

www.trend-uk.com



RECYCLABLE

trend[®]
routing technology

INST/M/RBT v2.0

OPERATION



The small diameter of the Mini Routabout template means that there is less leverage to rotate the template when compared to the standard Routabout. Extra care must be taken when routing and especially when routing the final cut.

- Screw the template with a No. 8 (4.0mm) countersink particleboard screw using a No. 2 Pozzi® screwdriver into the flooring board. The screw must be tight to ensure the template sits flat on the flooring, otherwise the router will rock. The template must be able to rotate.

- Locate the router, with the cutter and guide bush fitted, into the template.

- Set the depth of cut on the router with the router depth stop to ensure cut leaves 2mm of material at the bottom of the recess (ie. do not cut right through board). For 18mm board thickness: set the depth to 16mm and for 22mm board thickness set the depth to 20mm. This ensures centre waste piece is supported and that template will not slip, which can cause cutter damage to the board.



Set depth stop on router to leave 2mm of material at the bottom of the recess, before resetting depth for final cut.

- Rout at increased depths in a clockwise direction. Do not lean heavily on the router but allow the machine to do the work. Ensure the router pressure is kept at the front of the template where the router is seated but do not lean heavily on the template as this will make rotation more difficult. Lock the router plunge on each cut.

- Take a series of shallow passes until the router depth stop limits depth, (leaving a 2mm final cut). For the final cut reset plunge depth to cut final 2mm, but leave two bridges 20mm long on either side of the waste piece to hold it in position to the flooring board.



Ensure fixing screws do not foul the router base.

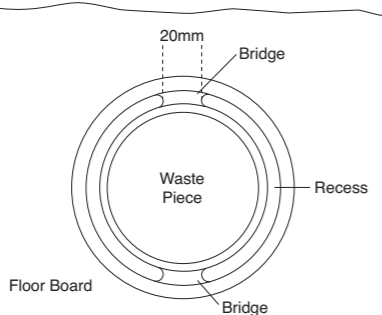

- Cut the two 2mm thick bridges that joint waste piece to flooring board using a suitable pad-saw to separate the waste piece.

- Unscrew the template from the waste piece, and then place template back into hole ensuring template fingers locate in the recess.

- Reset router depth of cut to allow cutter ball bearing to act as the final depth stop.

- Locate the router with cutter and guide bush fitted back into the template and carefully rout away both bridges in a clockwise direction. Take care that template fingers do not disengage from the recess.

- Cover is placed in the hole and the waste piece is disposed of. The same cover can be used for either floor thickness. The maximum load capacity on the cover must not exceed 380 kg.



If the bridges are not used then the waste piece will not support or hold the template centrally, this could cause the template to move and the router to slip and the cutter damaging the flooring.



Recommended speed is 24,000rpm.

After use of the jig, please store carefully.

TIPS FOR USE



- Remove nails in path of cutter before routing.
- Ensure the router, collet and cutter, are aligned correctly with the guide bush.
- Make sure the bearing on the router cutter is free and rotates freely before use.
- Always rout in a clockwise direction.
- Keep pressure towards the outside handle of the router when routing.
- Routers will have some lateral movement on the plunge in relation to the base, therefore when routing it is advisable to lock the plunge.

TROUBLE SHOOTING



There is an in-built tolerance between the jig, insert or cover. The ring will be a good fit in the hole, but not overly tight to allow for easy access. If the ring or insert is too tight, check:-

- Concentricity between guide bush and cutter.
- Routing direction is clockwise.
- A 30mm diameter guide bush is used.
- Pressure is applied to the outside handle of the router.
- Router plunge is locked for each pass.

SPARE PARTS

Please use only Trend original spare parts.

Item	Qty	Desc.	Ref. (1 off)
A	1	Mini Routabout Template	M/RBT/PLATE
B	1	Cutter 18mm x 1/4" Shank TCT	RBT/CUT/1
		Cutter 18mm x 1/2" Shank TCT	RBT/CUT/2
		Cutter 22mm x 1/4" Shank TCT Cutter 22mm x 1/2" Shank TCT	RBT/CUT/3 RBT/CUT/4
C	1	Mini Rbt Cover (pack 10)	M/RBT/C/10
		Mini Rbt Cover (pack 100)	M/RBT/C/100
D	1	30mm Plastic Guide Bush	GB/30/P
E	1	4.0mm (No. 8) x 25mm Woodscrew Pozzi	WP-SCW/100
		Instructions	INST/M/RBT

MAINTENANCE

Please use only Trend original spare parts and accessories.

This product has been designed to operate over along period of time with minimum maintenance. Continual satisfactory operation depends upon proper tool care and regular cleaning.

Cleaning

- Ensure clamping surfaces on cutter & collet are cleaned to remove dirt, grease and oil.
- Apply a rust protector to shanks. Do not use rust protector on ball bearing guides.
- Regularly clean jig with a soft cloth.
- Do not spray covers with PTFE spray.

Lubrication

- Your accessory requires no additional lubrication.

Storage

- Return cutter & jig to its packaging after use.

Safety Points

1. Disconnect power tool and attachment from power supply when not in use, before servicing, when making adjustments and when changing accessories such as cutters. Ensure switch is in "off" position and cutter has stopped rotating.
 2. Read and understand instructions supplied with power tool, attachment and cutter.
 3. Current Personal Protective Equipment (PPE) for eye, ear and respiratory protection must be worn. Keep hands, hair and clothes clear of the cutter.
 4. Before each use check cutter is sharp and free from damage. Do not use if cutter is dull, broken or cracked or if any damage is noticeable or suspected.
 5. The maximum speed (nmax) marked on tool or in instructions or on packaging shall not be exceeded. Where stated, the speed range should be adhered to.
 6. Insert the shank into the router collet at least all the way to the marked line indicated on the shank. This ensures at least 3/4 of shank length is held in collet. Ensure clamping surfaces are clean.
 7. Check all fixing and fastening nuts, bolts and screws on power tool, attachment and cutting tools are correctly assembled, tight and to correct torque setting before use.
 8. Ensure all visors, guards and dust extraction is fitted.
 9. The direction of routing must always be opposite to the cutter's direction of rotation.
 10. Do not switch power tool on with the cutter touching the workpiece.
 11. Trial cuts should be made in waste material before starting any project.
 12. Repair of tools is only allowed according to tool manufacturers instructions.
 13. Do not take deep cuts in one pass, take shallow passes to reduce the side load applied to the cutter.
- Please see www.trend-uk.com/safety for more safety advice.



Our policy of continuous improvements mean that specifications may change without notice. Trend Machinery & Cutting Tools Ltd. cannot be held liable for any material rendered unusable, or for any form of consequential loss.